

APPLICATION/AGREEMENT

For Trench/Disturbance Permit within the City of New Bedford

Permit # 100-2021
Dig Safe: 20211404434
Date: 4/6/2021

TO THE MAYOR AND CITY COUNCIL:

DISTURBANCE PERMIT/TRENCH SAFETY PERMIT

Permission is hereby requested to excavate the surface of: ☒ City Property and/or ☒ Private Property

Provide Sketch

Location of Work: 11 Holly St

Belleville Ave - North Front St

Gas Line Maintenance

Work will begin (weather permitting) on: April 20, 2021

Applicant Name: Kevin O'Sullivan (ra)

Excavator(s) Name: _____

Company Name: Eversource

Hoisting Equipment License Number: _____

Grade: _____ Expiration Date: _____

Contact Number: 508-441-5817

Name & Contact Number of Insurer: _____

Competent Person on Work Site: ON FILE

APPROVED BY: Stephen Caplan DATE: 4-15-2021

TITLE: Asst. City Engineer

This permit shall be posted at the work site, and shall remain until the work is completed. It is subject to inspection at all times.

ROADWAY CLOSURES WILL REQUIRE
AUTHORIZATION FROM THE
COMMISSIONER OF PUBLIC
INFRASTRUCTURE. TRAFFIC MANAGEMENT
PLANS MAY BE REQUIRED.

Permit only valid for three months
from date of approval

Trenches must be maintained
weekly until final paving is
completed

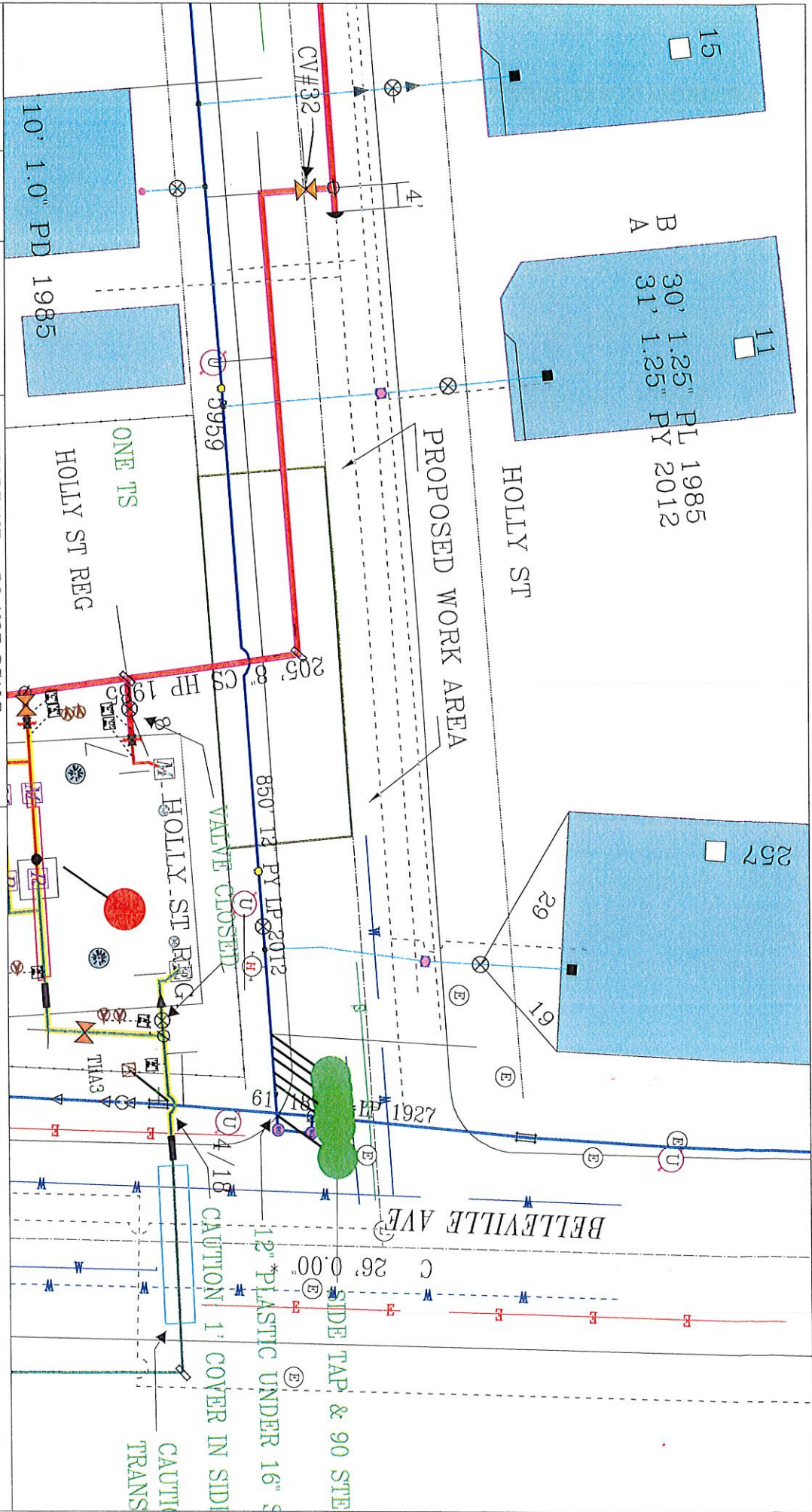

EVERSOURCE

MASS LAW
Before To have access
to a utility system
under a utility contract
Call Dig-Safe: 811

IMPORTANT - DO NOT SCALE
The drawings and/or specifications are for informational purposes only and do not constitute any
warranty or representation of the utility company. The utility company is not responsible for any
damages or injuries resulting from the use of these drawings or specifications. The utility company
is not responsible for any damages or injuries resulting from the use of these drawings or specifications.
The utility company is not responsible for any damages or injuries resulting from the use of these drawings or specifications.

Address: 11 Holly St SP
City / Town: New Bedford 4/1/2021

EVERSOURCE MA GAS
One NSTAR Way
Westwood, MA 02090
Phone 1-800-592-2000