

## APPLICATION/AGREEMENT

For Trench/Disturbance Permit within the City of New Bedford

Permit # 96-2020  
Dig Safe # 20200906878  
Date: 02/27/20

TO THE MAYOR AND CITY COUNCIL:

DISTURBANCE PERMIT/TRENCH SAFETY PERMIT

Permission is hereby requested to excavate the surface of: X City Property and/or X Private Property  
Provide SketchLocation of Work: 227 Church St.  
Glennon St. - Query St..Gas Line MaintenanceWork will begin (weather permitting) on: March 12, 2020Applicant Name: Robert Conklin Public Condition / SS Excavator(s) Name: \_\_\_\_\_Company Name: Eversource

Hoisting Equipment License Number: \_\_\_\_\_

Grade: \_\_\_\_\_ Expiration Date: \_\_\_\_\_

Contact Number: 508-441-5813

Name &amp; Contact Number of Insurer: \_\_\_\_\_

Competent Person on Work Site: ON FILEAPPROVED BY: Stephen Coughlin DATE: 3-5-2020TITLE: Asst. City Engineer

This permit shall be posted at the work site, and shall remain until the work is completed. It is subject to inspection at all times.

ROADWAY CLOSURES WILL REQUIRE  
AUTHORIZATION FROM THE  
COMMISSIONER OF PUBLIC  
INFRASTRUCTURE. TRAFFIC MANAGEMENT  
PLANS MAY BE REQUIRED.Permit valid only three  
months

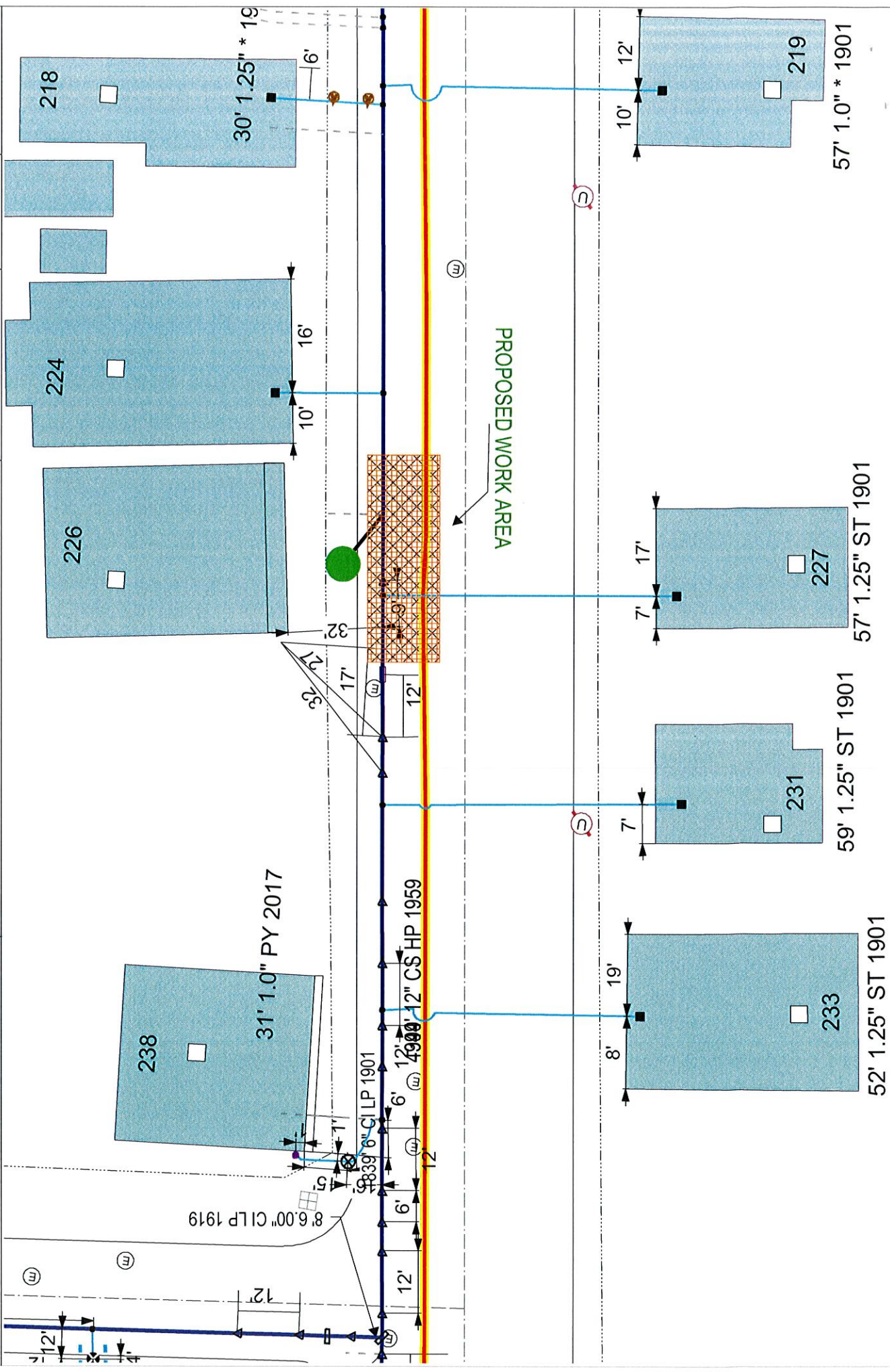

**EVERSOURCE**  
 EVERSOURCE MA GAS  
 One NSTAR Way  
 Westwood, MA 02090  
 Phone 1-800-592-2000



**MASS LAW**  
 Requires 72 hours advance  
 notice to Utility Companies  
 before digging by Anyone  
**Call Dig-Safe: 811**

**IMPORTANT - DO NOT SCALE**  
 This drawing provides approximate locations only and all facility information  
 may not be shown. Contact EVERSOURCE MA GAS to have specific field  
 information identified. EVERSOURCE MA GAS disclaims any liability resulting from  
 the reliance by any person on the location shown on this map. Massachusetts  
 law requires that any person performing excavation work contact Dig-Safe so  
 that the location of any underground may be marked.

**Address:** 227 CHURCH ST WL  
**City/Town:** NEW BEDFORD 2/26/20