

APPLICATION/AGREEMENT

Permit # 83-2020

For Trench/Disturbance Permit within the City of New Bedford

Dig Safe# 20200902502Date: 02/25/20

TO THE MAYOR AND CITY COUNCIL:

DISTURBANCE PERMIT/TRENCH SAFETY PERMIT

Permission is hereby requested to excavate the surface of: X City Property and/or X Private Property

Provide Sketch

Location of Work: Purchase St.

Wking from Maxfield St. - Hillman St.Relay Gas MainWork will begin (weather permitting) on: March 10, 2020Applicant Name: Robert Conklin Robert Conklin (No) Excavator(s) Name: _____Company Name: Eversource

Hoisting Equipment License Number: _____

Grade: _____ Expiration Date: _____

Contact Number: 508-441-5817

Name & Contact Number of Insurer: _____

Competent Person on Work Site: ON FILEAPPROVED BY: Stephen Crompton DATE: 3-3-2020TITLE: Asst. City Engineer

This permit shall be posted at the work site, and shall remain until the work is completed. It is subject to inspection at all times.

*permit valid for only three months*ROADWAY CLOSURES WILL REQUIRE
AUTHORIZATION FROM THE
COMMISSIONER OF PUBLIC
INFRASTRUCTURE. TRAFFIC MANAGEMENT
PLANS MAY BE REQUIRED.PATCH REPAIR:

Curb line to center of roadway.

Adjust structures as needed.

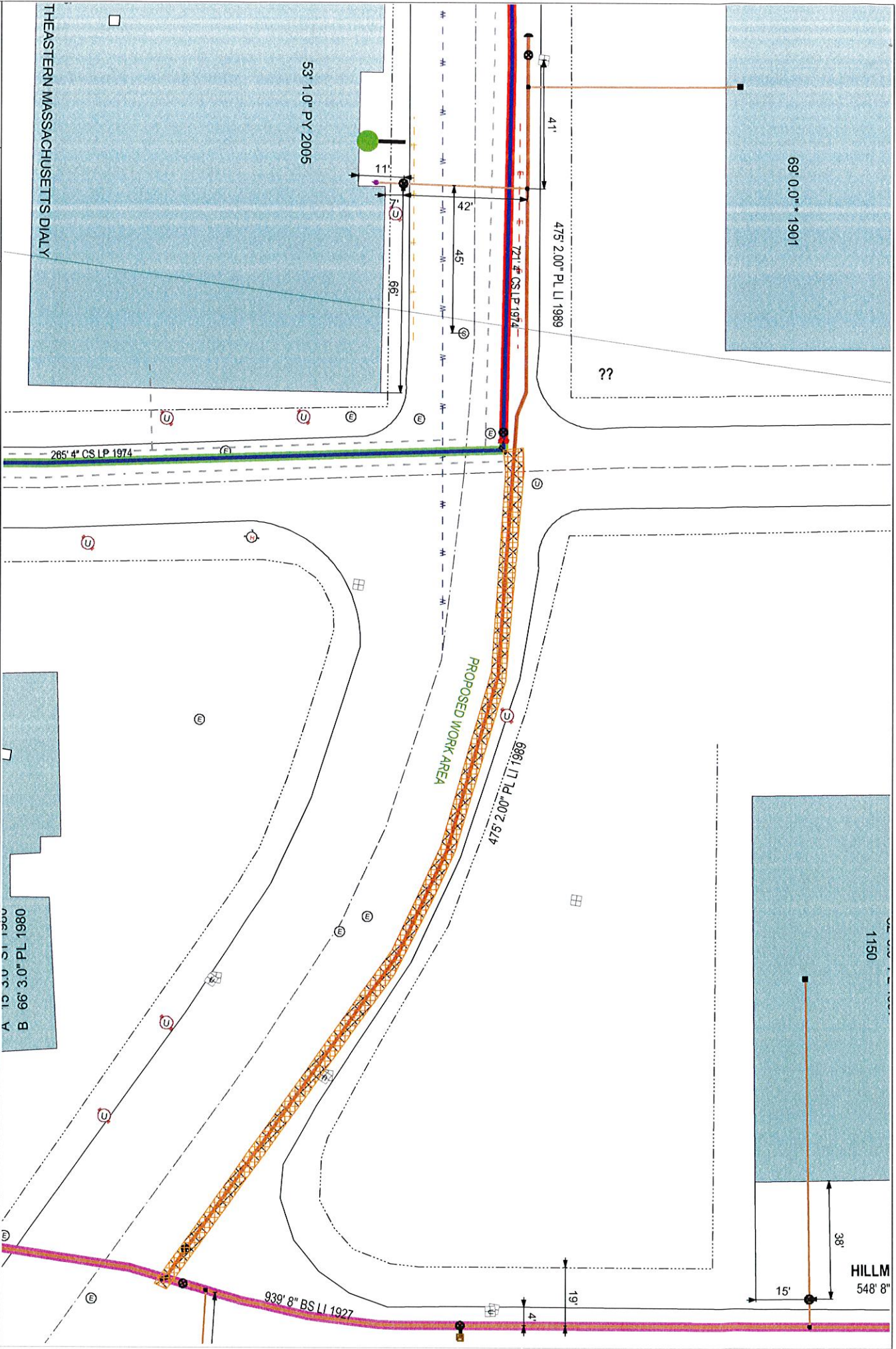

EVERSOURCE
EVERSOURCE MA GAS
One NSTAR Way
Westwood, MA 02090
Phone 1-800-592-2000



MASS LAW
Read and understand
notice to Utility Companies
before digging by Anyone
Call Dig-Safe: 811

IMPORTANT - DO NOT SCALE
This drawing provides approximate locations only and all facility information may not be shown. Contact EVERSOURCE MA GAS to have specific field information identified. EVERSOURCE MA GAS disclaims any liability resulting from the reliance by any person on the location shown on this map. Massachusetts law requires that any person performing excavation work contact Dig-Safe so that the location of any underground may be marked.

Address: Purchase St CD
City/Town: New Bedford 2/24/20