

## APPLICATION/AGREEMENT

Permit # 39-2020

For Trench/Disturbance Permit within the City of New Bedford

Dig Safe#20200307558

Date: 01/17/2020

TO THE MAYOR AND CITY COUNCIL:

DISTURBANCE PERMIT/TRENCH SAFETY PERMIT

Permission is hereby requested to excavate the surface of: X City Property and/or X Private Property  
Provide Sketch

Location of Work: 1602 – 1604 Acushnet Ave.

Earle St. – Davis St.

Relay Gas ServiceWork will begin (weather permitting) on: January 31, 2020Applicant Name: Robert Conklin Excavation Klein (\$5) Excavator(s) Name: \_\_\_\_\_Company Name: Eversource

Hoisting Equipment License Number: \_\_\_\_\_

Grade: \_\_\_\_\_ Expiration Date: \_\_\_\_\_

Contact Number: 508-441-5813

Name &amp; Contact Number of Insurer: \_\_\_\_\_

Competent Person on Work Site: ON FILEAPPROVED BY: [Signature] DATE: 1-27-2020

TITLE: \_\_\_\_\_

This permit shall be posted at the work site, and shall remain until the work is completed. It is subject to inspection at all times.

ROADWAY CLOSURES WILL REQUIRE  
AUTHORIZATION FROM THE  
COMMISSIONER OF PUBLIC  
INFRASTRUCTURE. TRAFFIC MANAGEMENT  
PLANS MAY BE REQUIRED.



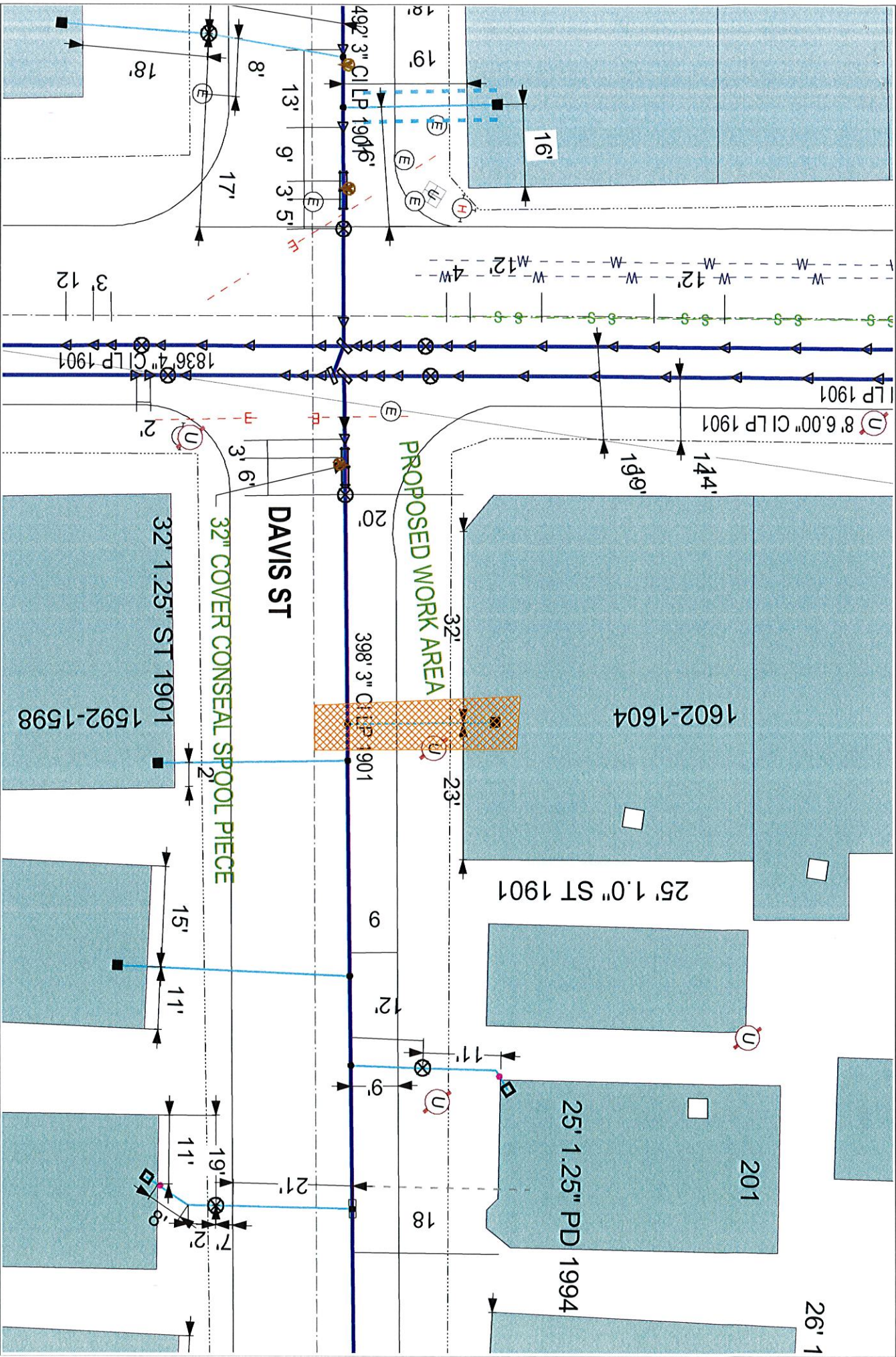

**EVERSOURCE**  
 EVERSOURCE MA GAS  
 One NSTAR Way  
 Westwood, MA 02090  
 Phone 1-800-592-2000



**MASS LAW**  
 Read and understand this notice to Utility Companies before digging by Anyone  
 Call Dig-Safe: 811

**IMPORTANT - DO NOT SCALE**  
 This drawing provides approximate locations only and all facility information may not be shown. Contact EVERSOURCE MA GAS to have specific field information identified. EVERSOURCE MA GAS disclaims any liability resulting from the reliance by any person on the location shown on this map. Massachusetts law requires that any person performing excavation work contact Dig-Safe so that the location of any underground may be marked.

**Address:** 1602-1604 Acushnet Ave SS  
**City/Town:** New Bedford 01/16/2020