

APPLICATION/AGREEMENT

For Trench/Disturbance Permit within the City of New Bedford

Permit # 315-2020
Dig Safe#20203102395
Date: 08/11/20

TO THE MAYOR AND CITY COUNCIL: DISTURBANCE PERMIT/TRENCH SAFETY PERMIT

Permission is hereby requested to excavate the surface of: X City Property and/or X Private Property
Provide Sketch

Location of Work: Timberlane Rd.

Working at Intersection of Briarwood Rd. _____

Gas Line Maintenance _____

Work will begin (weather permitting) on: August 25, 2020

Applicant Name: Craig Mello (ss) Excavator(s) Name: _____

Company Name: Eversource Hoisting Equipment License Number: _____

Grade: _____ Expiration Date: _____

Contact Number: 508-441-5817 Name & Contact Number of Insurer: _____

Competent Person on Work Site: ON FILE APPROVED BY: [Signature] DATE: 8/17/2020

TITLE: Sup. Civil Engineer

This permit shall be posted at the work site, and shall remain until the work is completed. It is subject to inspection at all times.

Permits are valid for only three months

ROADWAY CLOSURES WILL REQUIRE
AUTHORIZATION FROM THE
COMMISSIONER OF PUBLIC
INFRASTRUCTURE. TRAFFIC
MANAGEMENT PLANS MAY BE
REQUIRED.

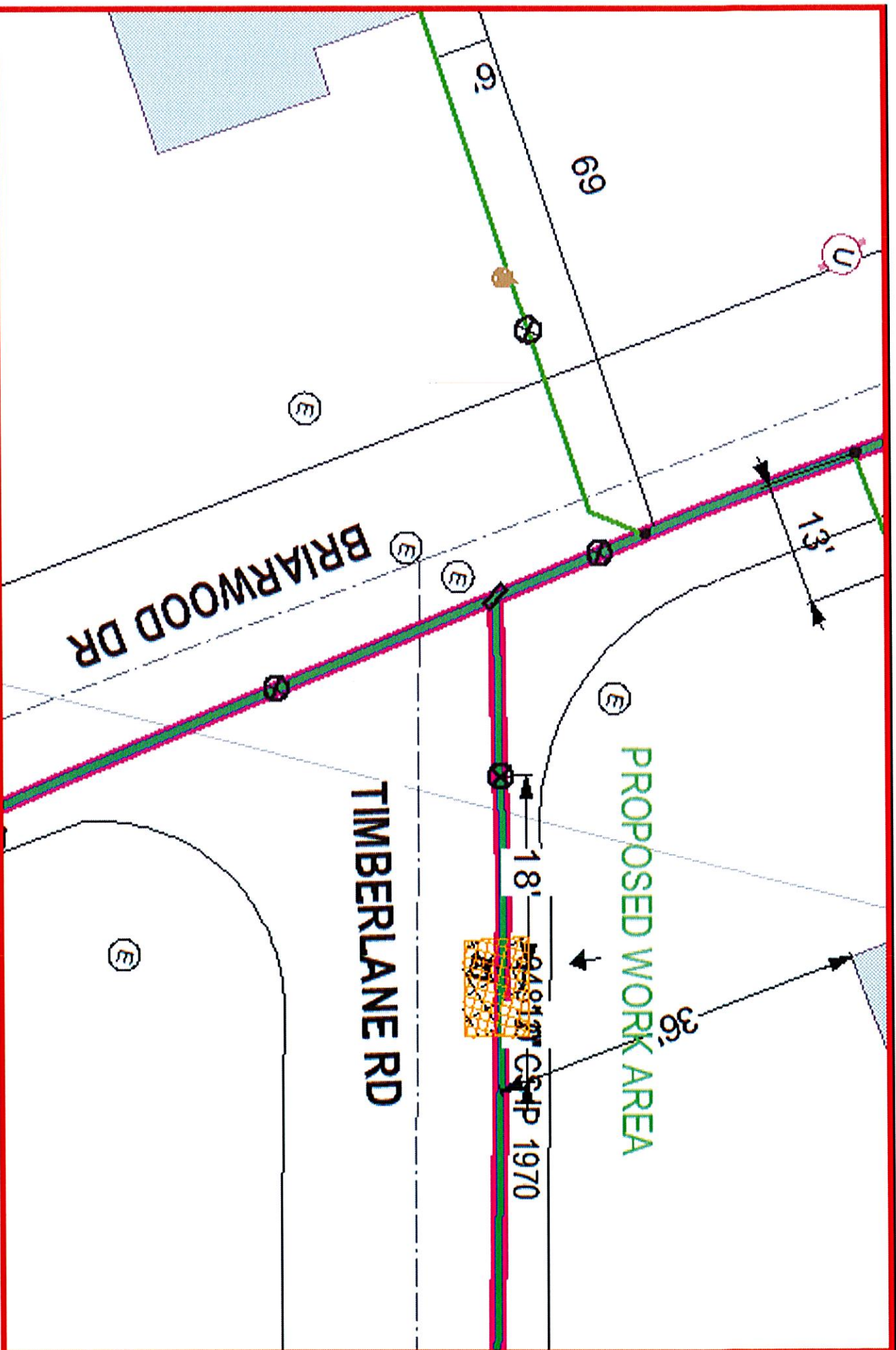

EVERSOURCE

EVERSOURCE GAS
ONE NUTMEG WAY
WILMINGTON, MA 01890
PHONE 1-800-255-5000

MASS LAW

Section 27B
Call Dig-Safe: 811

IMPORTANT - DO NOT SCALE

This drawing provides approximate locations only and all utility information may not be shown. Contractors are responsible for obtaining all utility information from the appropriate utility companies. The information provided is for informational purposes only and is not to be used for any other purpose. The information is provided for informational purposes only and is not to be used for any other purpose. The information is provided for informational purposes only and is not to be used for any other purpose.

Address: Timberlane Rd CD

City/Town: New Bedford 01970

Date Plotted: 05/29/2020