

APPLICATION/AGREEMENT  
For Trench/Disturbance Permit within the City of New Bedford

Permit # 217-2020  
Dig Safe#20202506684  
Date: 06/16/2020

TO THE MAYOR AND CITY COUNCIL:

DISTURBANCE PERMIT/TRENCH SAFETY PERMIT

Permission is hereby requested to excavate the surface of: X City Property and/or X Private Property  
Provide Sketch

Location of Work: Hathaway Rd., between Highland St & Nauset St. Working Street & Sidewalk. Start & include  
Intersection of Highland St. Work both sides of Street, go East to left side of #66 (Bowling Alley).

Relay Gas Main & Services

Work will begin (weather permitting) on: June 30, 2020

Work will end (weather permitting) on: 60 days

Applicant Name: Robert Conklin (gk) Excavator(s) Name: \_\_\_\_\_

Company Name: Eversource Hoisting Equipment License Number: \_\_\_\_\_

Grade: \_\_\_\_\_ Expiration Date: \_\_\_\_\_

Contact Number: 508-441-5817 Name & Contact Number of Insurer: \_\_\_\_\_

Competent Person on Work Site: ON FILE APPROVED BY: Adam Scott DATE: 6/16/2020

TITLE: Sup. Civil Engineer

This permit shall be posted at the work site, and shall remain until the work is completed. It is subject to inspection at all times.

*Sidewalk work must be replaced w/ cem. conc.  
and be ADA compliant*

Permits are valid for only three months

ROADWAY CLOSURES WILL REQUIRE  
AUTHORIZATION FROM THE  
COMMISSIONER OF PUBLIC  
INFRASTRUCTURE. TRAFFIC  
MANAGEMENT PLANS MAY BE  
REQUIRED.

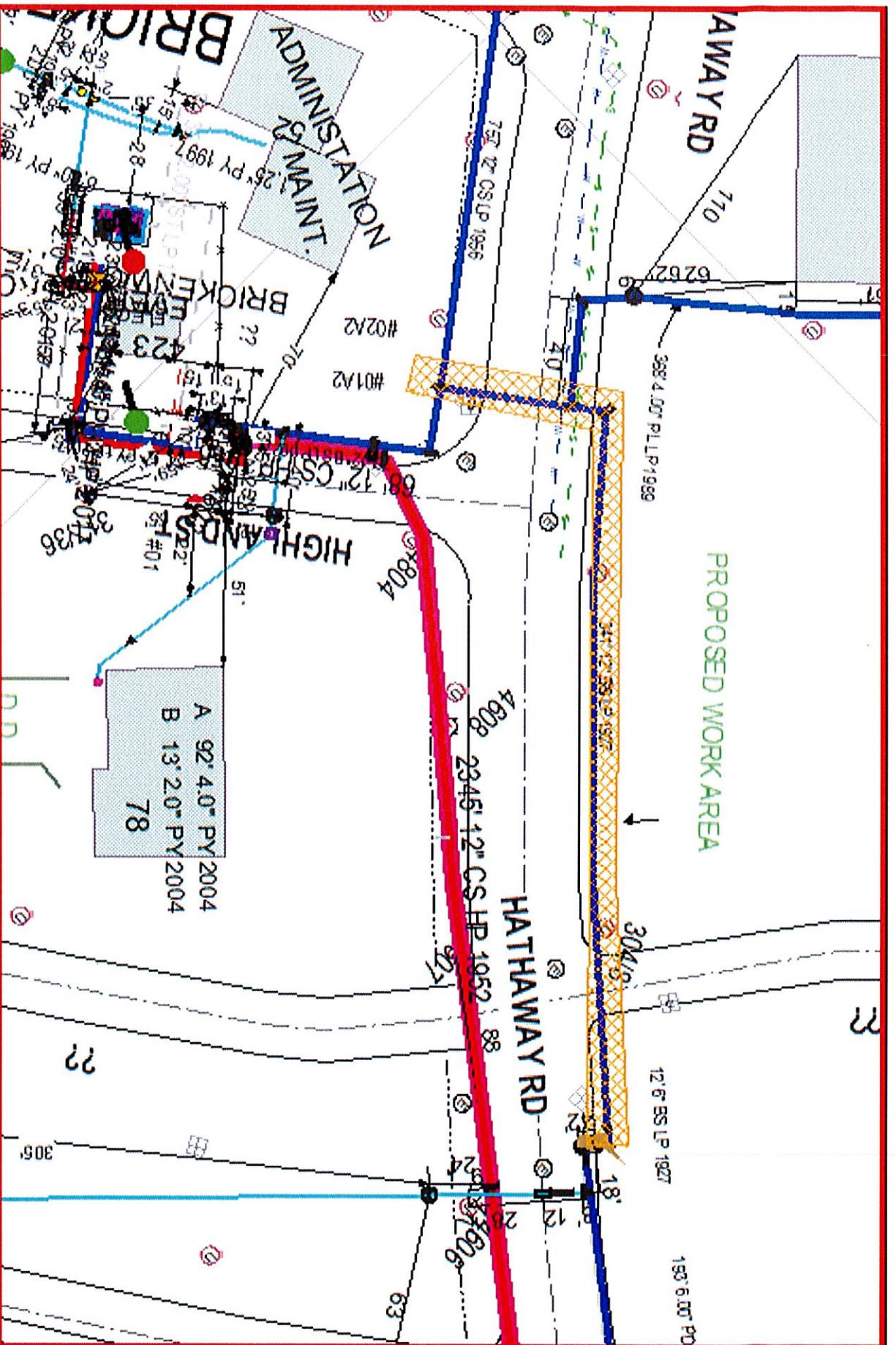

**EVERSOURCE**

EVERSOURCE GAS  
ONE NORTH AVENUE  
WATSONVILLE, CA 95076  
PHONE 1-800-255-2000



**MASS LAW**

MASS LAW  
MASS LAW  
MASS LAW

Call Dig-Safe: 811

**IMPORTANT - DO NOT SCALE**

The drawing shows approximate locations only and all field information may not be shown. Consult the project engineer for all field information. Information provided is for informational purposes only and does not constitute a warranty. The user assumes all liability for any use of this information. The user assumes all liability for any use of this information. The user assumes all liability for any use of this information.

Address: Hathaway Rd CD

City/Town: New Bedford 6/13/20

Date Plotted: 05/14/2020