

APPLICATION/AGREEMENT  
For Trench/Disturbance Permit within the City of New Bedford

Permit # 11-2020  
Dig Safe# 20200202467  
Date: 01/07/20

TO THE MAYOR AND CITY COUNCIL: DISTURBANCE PERMIT/TRENCH SAFETY PERMIT

Permission is hereby requested to excavate the surface of: X City Property and/or X Private Property  
Provide Sketch

Location of Work: Myrtle St.  
Sawyer St – Cedar Grove St

Relay Gas Main

Work will begin (weather permitting) on: January 21, 2020

Applicant Name: Robert Conklin *Robert Conklin (SS)* Excavator(s) Name: \_\_\_\_\_

Company Name: Eversource Hoisting Equipment License Number: \_\_\_\_\_  
Grade: \_\_\_\_\_ Expiration Date: \_\_\_\_\_

Contact Number: 508-441-5813 Name & Contact Number of Insurer: \_\_\_\_\_

Competent Person on Work Site: ON FILE

APPROVED BY: Stephen Crompton DATE: 1-13-2020

TITLE: Asst. City Engineer

**This permit shall be posted at the work site, and shall remain until the work is completed. It is subject to inspection at all times.**

ROADWAY CLOSURES WILL REQUIRE  
AUTHORIZATION FROM THE  
COMMISSIONER OF PUBLIC  
INFRASTRUCTURE. TRAFFIC MANAGEMENT  
PLANS MAY BE REQUIRED.

*permit valid only three months*



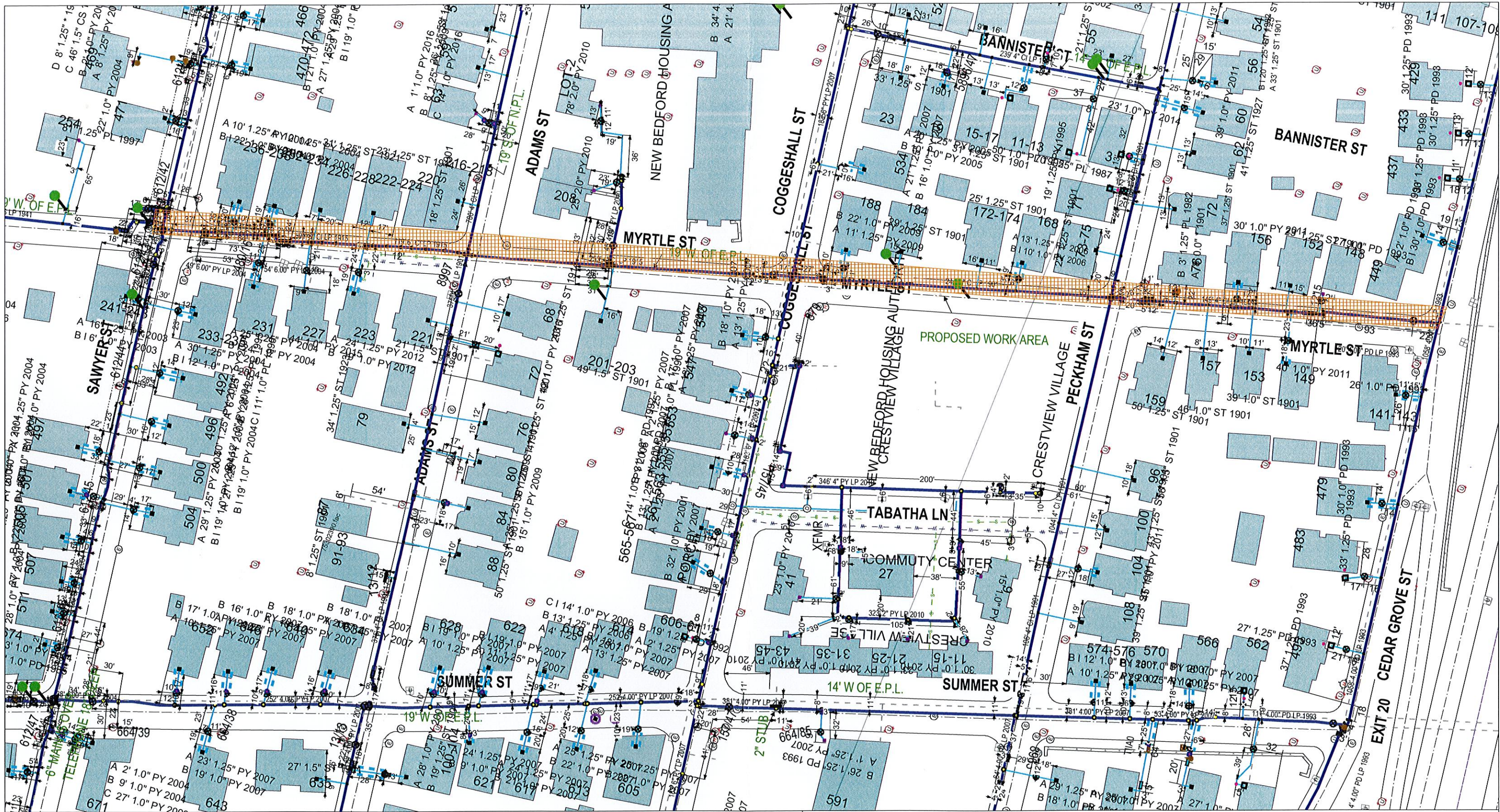

EVERSOURCE

MASS LAW

Requires 72 hours advance notice to Utility Companies before digging by Anyone

Call Dig-Safe: 811

IMPORTANT - DO NOT SCALE

This drawing provides approximate locations only and all facility information may not be shown. Contact EVERSOURCE MA Gas to have specific field information identified. EVERSOURCE MA Gas disclaims any liability resulting from reliance by any on the location shown on this map. Massachusetts law requires that any person performing excavation work contact Dig-Safe so that the location of any underground may be marked

Address:

Myrtle St CD

City / Town:

New Bedford 1/3/20