

Expires 12-9-20

PERMIT NO.
24854



CITY OF NEW BEDFORD
SEWER AND/OR STORM DRAIN PERMIT

DATE 12/9/19

This certifies that permission is granted to

887 Mt Pleasant St. Evangeline Lemus
Property Owner Address Tel. 508.998.5522

To connect a sewer and/or storm drain located at 887 Mt Pleasant St 3' DK
Assessor's Plot 123 Lot 304 to the sewer and/or storm drain in England St 3' DK Street

To be laid in accordance with the conditions in this application and the City of New Bedford ordinances.
TYPE OF USE: RESIDENTIAL COMMERCIAL INDUSTRIAL FLOW G.P.D.

If applicant other than actual property owner, attach Letter of Authorization from Property Owner.
Name: John J. Debono, Sultan, MA Tel. 508.998.8522
Mailing Address: 1803 Cranford St, New Bedford, MA
The Bonded Contractor/Drain Layer authorized to perform this work is:
RJ Peres, PO Box 51643, NB Tel. 508.998.3404
Name Tel.
Type of Pipe Required: 6" PVC SDR

PERMIT EXPIRES ONE YEAR AFTER DATE OF ISSUE

- Requires separate connections for sewage and storm drain where applicable. Storm water cannot be discharged to a sanitary sewer.
- All work must be inspected and approved by a D.P.I. inspector before backfilling.
- If this connection is to be part of a private service shared jointly with other building owners, attach copy of Recorded Joint Maintenance Agreement.
- Permits can be issued to Industrial and/or Commercial Applicants only upon receipt and approval by the Commissioner of Public Infrastructure of required plans and supplemental information.
- In addition, a City-issued Industrial User Discharge Permit and/or a Sewer Extension/Connection Permit issued by the Commonwealth of Massachusetts D.E.P. shall be required by the City for Industrial Discharge into the sewer system.

Comm. Mass. Sewer Conn./Ext. Permit No. #19-12 Date 10-29-19

A Filing and Inspection Fee of \$450, plus an Entrance Fee of \$145.8 where applicable, must accompany this application.

Bank# 003085 Check# 3685 Date 12.6.19 Receipt# 2553855-Stub

Other requirements:

Connection made to Sewer Part of jointly-shared private line YES NO

Applicant agrees to abide by the above terms, as well as all pertinent ordinances of the City of New Bedford, and such other special rules as the Commissioner of Public Infrastructure and/or City Engineer may deem necessary

Signature of City Engineer

Signature of Property Owner or Representative

INSPECTOR'S REPORT

INSPECTED BY:

DATE:

COMMENTS:

APPROVED

DISAPPROVED

SIGNATURE

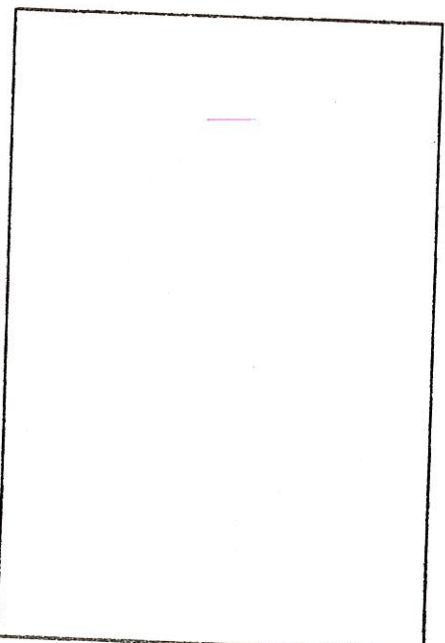

SKETCH PLAN



Department of Public Infrastructure

Jamie Ponte
Commissioner

CITY OF NEW BEDFORD
Jonathan F. Mitchell, Mayor

Water
Wastewater
Highways
Engineering
Cemeteries
Park Maintenance
Forestry
Energy

To Whom It May Concern:

I Therese Lee Jones 887 Mt. Pleasant St. (Name)
(Mailing Address), being

Owner of property located at

887 Mt. Pleasant St.

Plot , Lot , hereby agree to allow John A. Wokosak (Name)
1303 Palmer St. N.B. (Mailing Address), to act on my behalf including affixing my

signature in securing permit for:

- ☒ Sewer/Drain Service Permits
☐ Water Service Permits
☐ Driveway Installation Permits
☐ Sidewalk Installation Permits

I further agree to conform to, and abide by, All City rules and ask regulations applicable to the permit (s) being applied for:

Name Therese Lee Jones Signature
Address 887 Mt. Pleasant St.
Date 11/25/19 Telephone Number 508-99-5850

Proposed New Sewer Connection
For 887 MT. PLEASANT ST.
To Be installed By R.J. CANESSA

ATT. MANNY SILVA

887 ENGLAND ST.

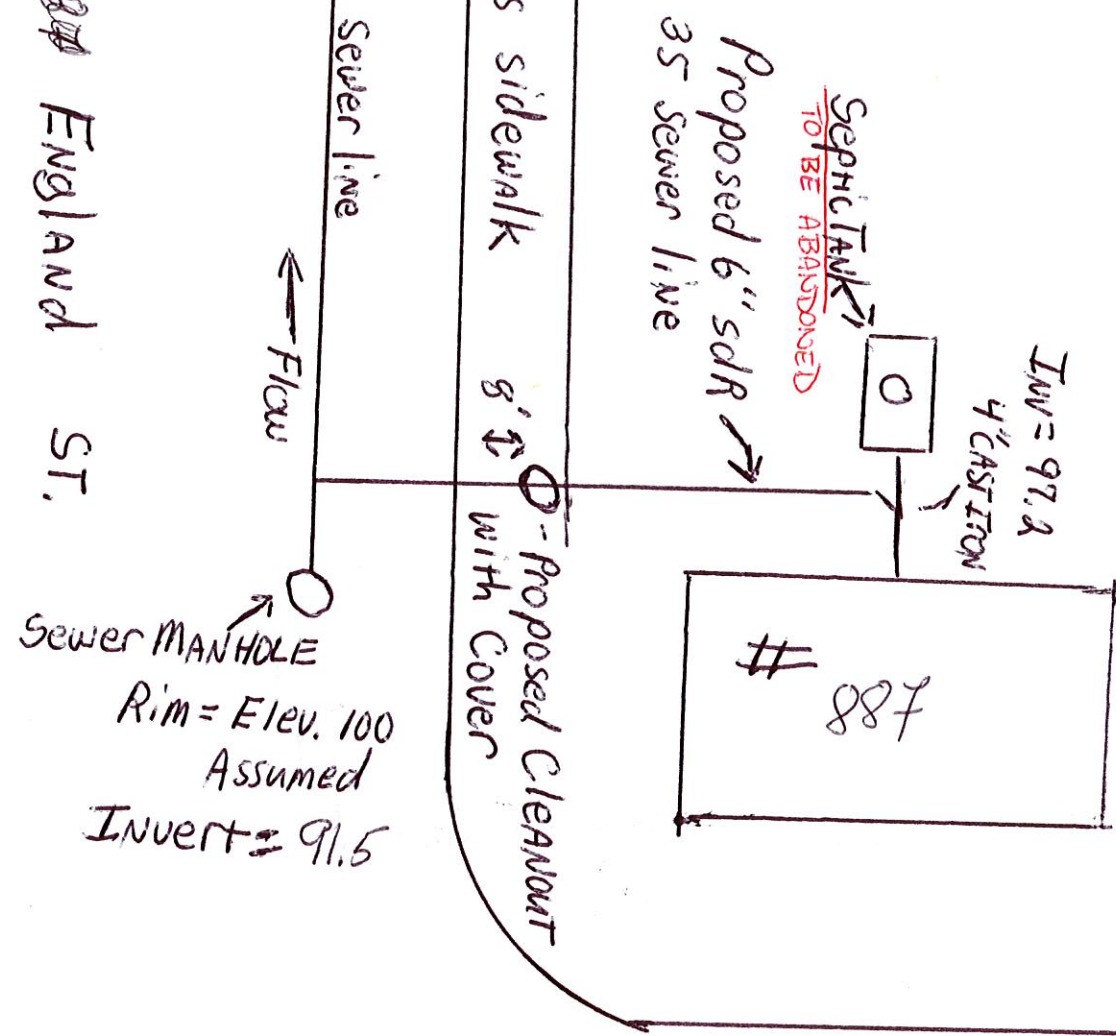

MT. PLEASANT ST.

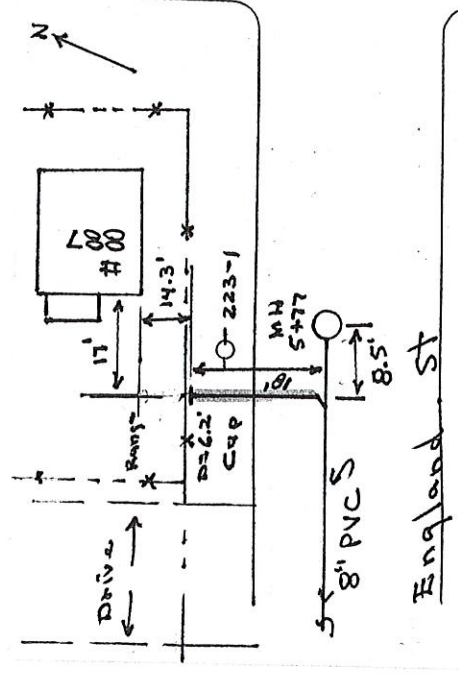

Mt. Pleasant St.

21

01

06

000

ENGLAND

MILLER

8" PVC SEWER

24315-2013

22891-99

22838-99

24552-2017

24126-2009

21158-86

22969-2000

2" FORCE MAIN FOR JOINT MAINT. ACCIDENT AND E PERMIT APPLICATION FILE FOR JOINT MAINT. ACCIDENT AND STRICTIONS ON USE OF THIS LINE, TO JONES ST. 25.

142

4-89