

## APPLICATION/AGREEMENT

Permit # 585-19

For Trench/Disturbance Permit within the City of New Bedford

Dig Safe#20194802219

Date: 11/26/19

TO THE MAYOR AND CITY COUNCIL:

DISTURBANCE PERMIT/TRENCH SAFETY PERMIT

Permission is hereby requested to excavate the surface of : X City Property and/or X Private Property

Provide Sketch

Location of Work: 111 & 112 Mashpee Court  
Navahoe Court.Gas Line MaintenanceWork will begin (weather permitting) on: December 10, 2019Applicant Name: Robert Conklin Robert Conklin(SS)

Excavator(s) Name: \_\_\_\_\_

Company Name: Eversource

Hoisting Equipment License Number: \_\_\_\_\_

Grade: \_\_\_\_\_ Expiration Date: \_\_\_\_\_

Contact Number: 508-441-5813

Name &amp; Contact Number of Insurer: \_\_\_\_\_

Competent Person on Work Site: ON FILEAPPROVED BY: Stephen Cuyler DATE: 12-5-2019TITLE: Asst. City Engineer

This permit shall be posted at the work site, and shall remain until the work is completed. It is subject to inspection at all times.

ROADWAY CLOSURES WILL REQUIRE  
AUTHORIZATION FROM THE  
COMMISSIONER OF PUBLIC  
INFRASTRUCTURE. TRAFFIC MANAGEMENT  
PLANS MAY BE REQUIRED.

Permit valid for three months

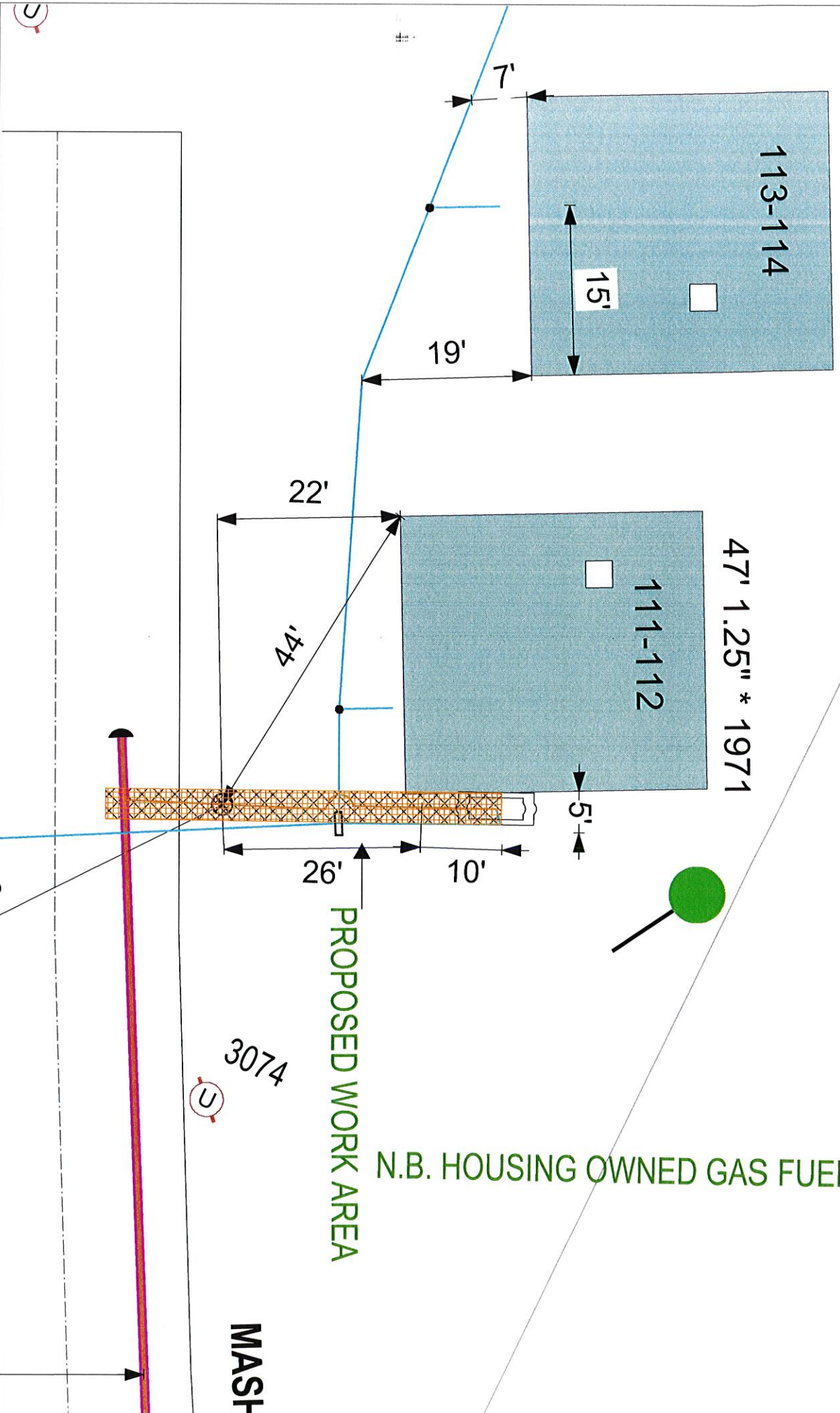

**EVERSOURCE**  
EVERSOURCE MA GAS  
One NSTAR Way  
Westwood, MA 02090  
Phone 1-800-592-2000

**MASS LAW**  
Requires 72 hours advance  
notice of excavation  
before digging by Anyone  
Call Dig-Safe: 811

**IMPORTANT - DO NOT SCALE**  
This drawing provides approximate locations only and all facility information  
may not be shown. Contact EVERSOURCE MA GAS to have specific field  
information identified. EVERSOURCE MA GAS disclaims any liability resulting from  
the reliance by any person on the location shown on this map. Massachusetts  
law requires that any person performing excavation work contact Dig-Safe so  
that the location of any underground may be marked.

**Address:** 111-112 Mashpee Ct CD  
**City/Town:** New Bedford 11/23/19