

APPLICATION/AGREEMENT
For Trench/Disturbance Permit within the City of New Bedford

Permit # 521-19
Dig Safe#20194304148
Date: 10/22/2019

TO THE MAYOR AND CITY COUNCIL: DISTURBANCE PERMIT/TRENCH SAFETY PERMIT

Permission is hereby requested to excavate the surface of: ☒ City Property and/or ☐ Private Property
Provide Sketch

Location of Work: 114 Butler St.

Working between Swan St. & Moss St.

~~Working in Street & Street to House~~

~~Gas line maintenance~~

Work will begin (weather permitting) on: November 5, 2019

Work will end (weather permitting) on: 60 days

Applicant Name: Robert Conkin *Robert Conkin* Excavator(s) Name: _____

Company Name: Eversource _____ Hoisting Equipment License Number: _____

Grade: _____ Expiration Date: _____

Contact Number: 508-441-5817 _____ Name & Contact Number of Insurer: _____

Competent Person on Work Site: ON FILE _____ APPROVED BY: *Stephen Crompton* DATE: *10-25-2019*

TITLE: *Engineering Supervisor* _____

This permit shall be posted at the work site, and shall remain until the work is completed. It is subject to inspection at all times.

FOR INSPECTION ONLY A 24 HOUR
NOTICE IS REQUIRED AND THE
CONTRACTOR/APPLICANT IS
REQUIRED TO NOTIFY THE D.P.L.
@ 508 979-1550 Press 4 Repair
~~PERMIT EXPIRES 1 YEAR~~ *3 months*

ROADWAY CLOSURES WILL REQUIRE
AUTHORIZATION FROM THE
COMMISSIONER OF PUBLIC
INFRASTRUCTURE. TRAFFIC MANAGEMENT
PLANS MAY BE REQUIRED.

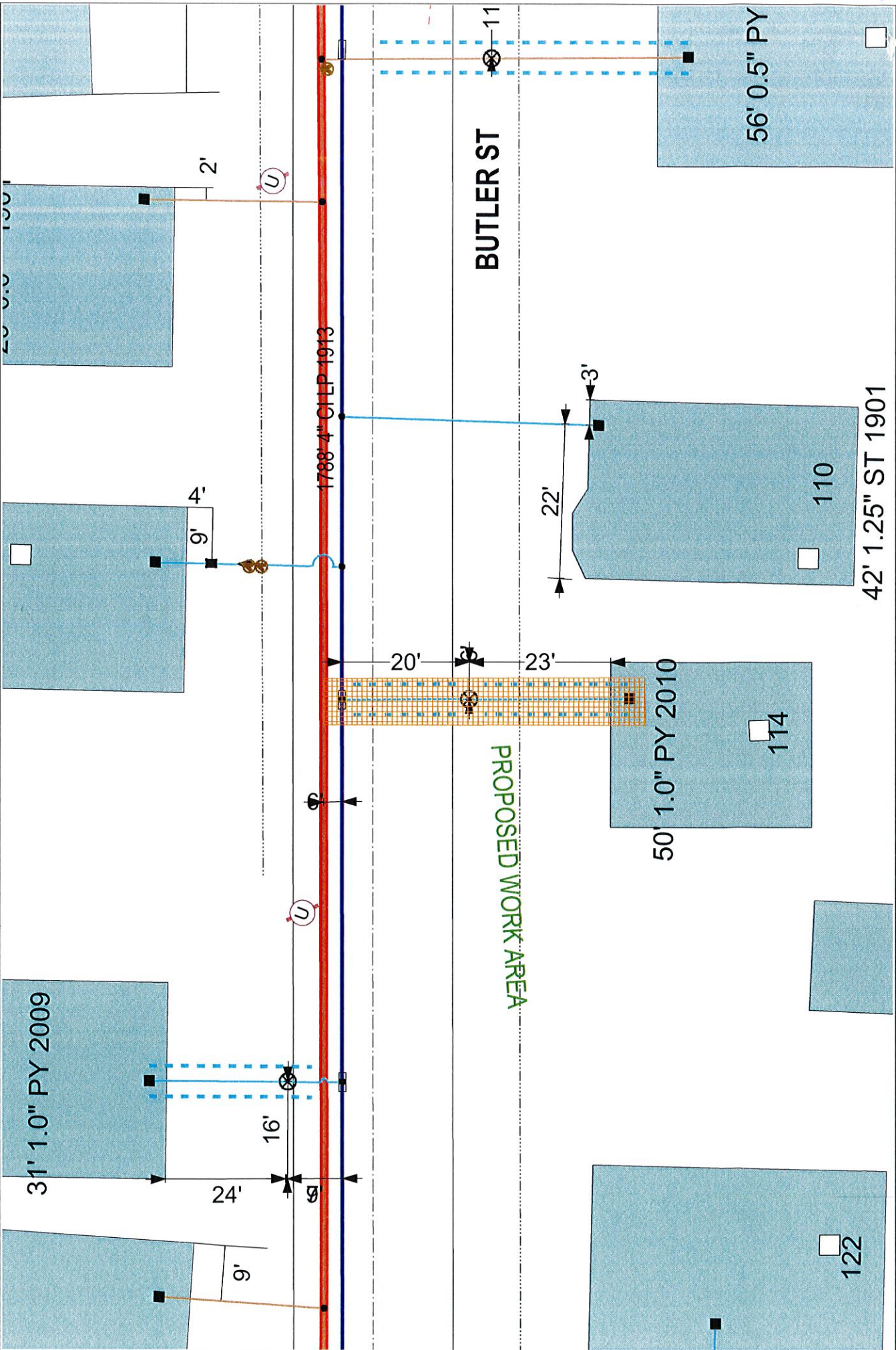

BUTLER ST

PROPOSED WORK AREA

1788' 4" CHLP 1913

EVERSOURCE

EVERSOURCE MA GAS
One NSTAR Way
Westwood, MA 02090
Phone 1-800-592-2000

MASS LAW

Notice to Utility Companies
before digging by Anyone

Call Dig-Safe: 811

IMPORTANT - DO NOT SCALE

This drawing provides approximate locations only and all facility information may not be shown. Contact EVERSOURCE MA GAS to have specific field information identified. EVERSOURCE MA GAS disclaims any liability resulting from the reliance by any person on the location shown on this map. Massachusetts law requires that any person performing excavation work contact Dig-Safe so that the location of any underground may be marked.

Address: 114 Butler St. SS

City/Town: New Bedford 10/21/2019

Date Plotted: 10/21/2019