

APPLICATION/AGREEMENT

For Trench/Disturbance Permit within the City of New Bedford

Permit # 507-19
Dig Safe#20194100366
Date: 10/07/19

TO THE MAYOR AND CITY COUNCIL: DISTURBANCE PERMIT/TRENCH SAFETY PERMIT

Permission is hereby requested to excavate the surface of: ☒ City Property and/or ☐ Private Property

Provide Sketch

Location of Work: 210 Caroline St.

Durfee St. - Austin St

Install Gas Service

Work will begin (weather permitting) on: October 21, 2019

Applicant Name: Robert Conklin Excavator(s) Name: _____

Company Name: Eversource

Hoisting Equipment License Number: _____

Grade: _____ Expiration Date: _____

Contact Number: 508-441-5817 Name & Contact Number of Insurer: _____

Competent Person on Work Site: ON FILE

APPROVED BY: Stephen Cuyper DATE: 10-21-2019

TITLE: Assistant City Engineer

This permit shall be posted at the work site, and shall remain until the work is completed. It is subject to inspection at all times.

FOR INSPECTION ONLY A 24 HOUR
NOTICE IS REQUIRED AND THE
CONTRACTOR/APPLICANT IS
REQUIRED TO NOTIFY THE D.P.L.
@ 508 979-1550 Press 4 Repair
~~PERMIT EXPIRES 1 YEAR~~ 3 months

ROADWAY CLOSURES WILL REQUIRE
AUTHORIZATION FROM THE
COMMISSIONER OF PUBLIC
INFRASTRUCTURE. TRAFFIC MANAGEMENT
PLANS MAY BE REQUIRED.

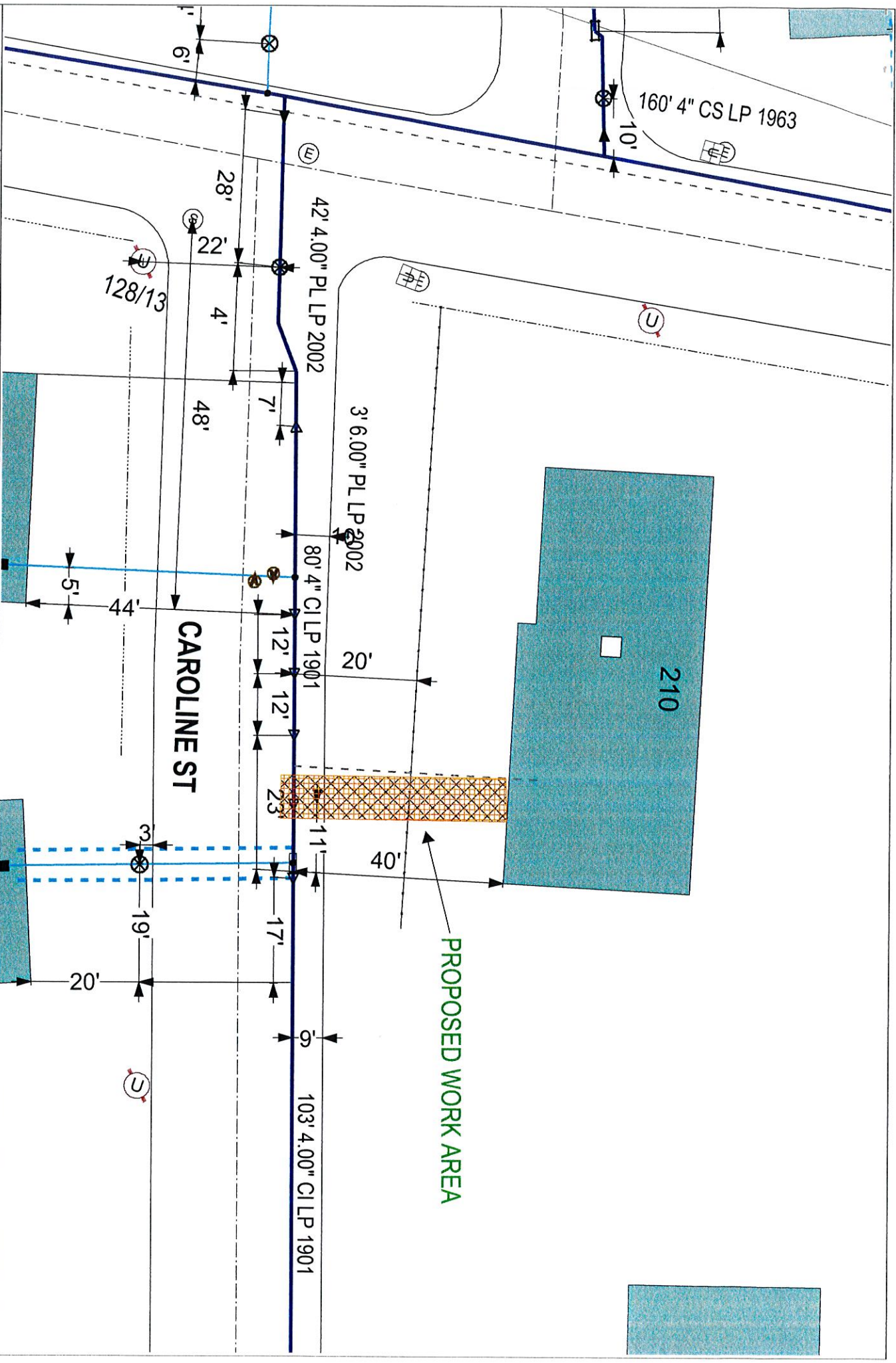

PROPOSED WORK AREA

EVERSOURCE

EVERSOURCE MA GAS
One NSTAR Way
Westwood, MA 02090
Phone 1-800-592-2000

MASS LAW

Requires 30 days advance
notice to Utility Companies
before digging by Anyone

Call Dig-Safe: 811

IMPORTANT - DO NOT SCALE

This drawing provides approximate locations only and all facility information may not be shown. Contact EVERSOURCE MA GAS to have specific field information identified. EVERSOURCE MA GAS disclaims any liability resulting from the reliance by any person on the location shown on this map. Massachusetts law requires that any person performing excavation work contact Dig-Safe so that the location of any underground may be marked.

Address: 210 CAROLINE ST WAL

City/Town: NEW BEDFORD 10/3/19