

APPLICATION/AGREEMENT

Permit # 502-19

For Trench/Disturbance Permit within the City of New Bedford

Dig Safe#20194211582

Date: 10/18/19

TO THE MAYOR AND CITY COUNCIL:

DISTURBANCE PERMIT/TRENCH SAFETY PERMIT

Permission is hereby requested to excavate the surface of : X City Property and/or X Private Property

Provide Sketch

Location of Work: 1011 Ashley Blvd.

Menton St. - York St.Install Gas ServiceWork will begin (weather permitting) on: November 1, 2019Applicant Name: Robert Conkling

Excavator(s) Name: _____

Company Name: Eversource

Hoisting Equipment License Number: _____

Grade: _____ Expiration Date: _____

Contact Number: 508-441-5817

Name & Contact Number of Insurer: _____

Competent Person on Work Site: ON FILEAPPROVED BY: Stephen Crompton DATE: 10-21-2019TITLE: Asst. City Engineer

This permit shall be posted at the work site, and shall remain until the work is completed. It is subject to inspection at all times.

FOR INSPECTION ONLY A 24 HOUR
NOTICE IS REQUIRED AND THE
CONTRACTOR/APPLICANT IS
REQUIRED TO NOTIFY THE D.P.I.
@ 508 979-1550 Press 4 Repair
PERMIT EXPIRES ~~1 YEAR~~ 3 months

ROADWAY CLOSURES WILL REQUIRE
AUTHORIZATION FROM THE
COMMISSIONER OF PUBLIC
INFRASTRUCTURE. TRAFFIC MANAGEMENT
PLANS MAY BE REQUIRED.

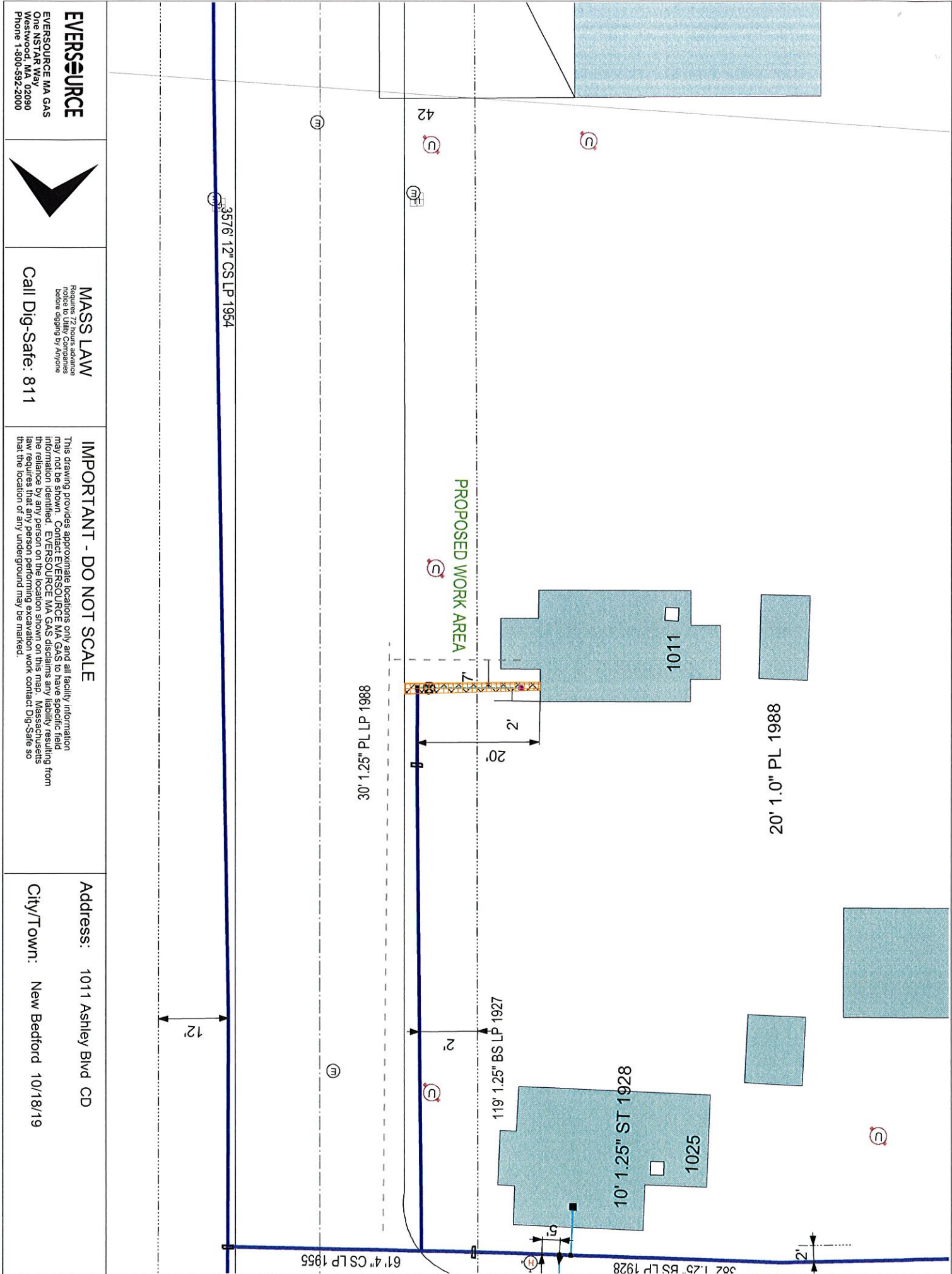

EVERSOURCE

EVERSOURCE MA GAS
One NSTAR Way
Westwood, MA 02090
Phone 1-800-592-2000



MASS LAW

Requires 72 hours advance
notice to Utility Companies
before digging by Anyone

Call Dig-Safe: 811

IMPORTANT - DO NOT SCALE

This drawing provides approximate locations only and all facility information may not be shown. Contact EVERSOURCE MA GAS to have specific field information identified. EVERSOURCE MA GAS disclaims any liability resulting from the reliance by any person on the location shown on this map. Massachusetts law requires that any person performing excavation work contact Dig-Safe so that the location of any underground may be marked.

Address: 1011 Ashley Blvd CD

City/Town: New Bedford 10/18/19

Date Plotted: 10/18/2019