

APPLICATION/AGREEMENT
For Trench/Disturbance Permit within the City of New Bedford

Permit # 472-19
Dig Safe#20194003854
Date: 10/01/2019

TO THE MAYOR AND CITY COUNCIL: DISTURBANCE PERMIT/TRENCH SAFETY PERMIT

Permission is hereby requested to excavate the surface of: ☒ City Property and/or ☐ Private Property
Provide Sketch

Location of Work: 115 Whinnan St.
Working from Madeira Ave & N. Front St

Relay of gas service

Work will begin (weather permitting) on: October 15, 2019

Work will end (weather permitting) on: 60 days

Applicant Name: Robert Conklin Excavator(s) Name: Robert Conklin (GR)

Company Name: Eversource

Hoisting Equipment License Number: _____
Grade: _____ Expiration Date: _____

Contact Number: 508-441-5819

Name & Contact Number of Insurer: _____

Competent Person on Work Site: ON FILE

APPROVED BY: Stephan Cuytara DATE: 10-16-2019
TITLE: Engineering Supervisor

This permit shall be posted at the work site, and shall remain until the work is completed. It is subject to inspection at all times.

FOR INSPECTION ONLY A 24 HOUR
NOTICE IS REQUIRED AND THE
CONTRACTOR/APPLICANT IS
REQUIRED TO NOTIFY THE D.P.L.
@ 508 979-1550 Press 4 Repair
~~PERMIT EXPIRES 1 YEAR~~ 3 months

1/2 st?

ROADWAY CLOSURES WILL REQUIRE
AUTHORIZATION FROM THE
COMMISSIONER OF PUBLIC
INFRASTRUCTURE. TRAFFIC MANAGEMENT
PLANS MAY BE REQUIRED.

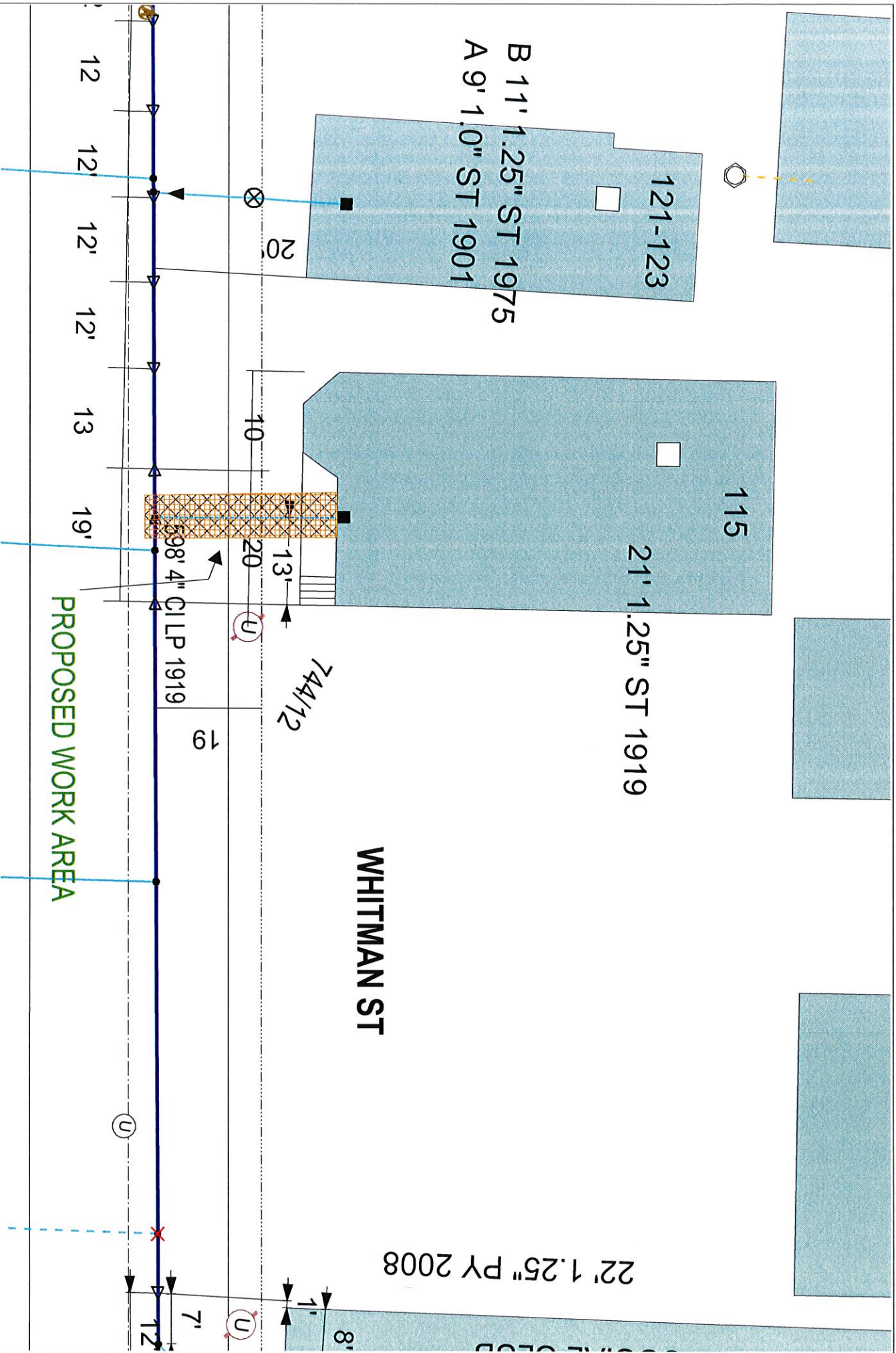

EVERSOURCE
EVERSOURCE MA GAS
One NSTAR Way
Westwood, MA 02090
Phone 1-800-592-2000



MASS LAW
Requires 72 hours advance
notice to be given
before digging by anyone
Call Dig-Safe: 811

IMPORTANT - DO NOT SCALE
This drawing provides approximate locations only and all facility information
may not be shown. Contact EVERSOURCE MA GAS to have specific field
information identified. EVERSOURCE MA GAS disclaims any liability resulting from
the reliance by any person on the location shown on this map. Massachusetts
law requires that any person performing excavation work contact Dig-Safe so
that the location of any underground may be marked.

Address: 115 WHITMAN ST WAL
City/Town: NEW BEDFORD 9/13/19