

APPLICATION/AGREEMENT

Permit # 471-19

For Trench/Disturbance Permit within the City of New Bedford

Dig Safe#20194003858

Date: 10/01/2019

TO THE MAYOR AND CITY COUNCIL:

DISTURBANCE PERMIT/TRENCH SAFETY PERMIT

Permission is hereby requested to excavate the surface of: X City Property and/or X Private Property
Provide SketchLocation of Work: 1022 Chaffee St.
Between Acushnet Ave & Ashley Blvd.Gas Line MaintenanceWork will begin (weather permitting) on: October 15, 2019Work will end (weather permitting) on: 60 daysApplicant Name: Robert Conklin Robert Conklin Excavator(s) Name: _____
(85)Company Name: Eversource Hoisting Equipment License Number: _____

Grade: _____ Expiration Date: _____

Contact Number: 508-441-5819 Name & Contact Number of Insurer: _____Competent Person on Work Site: ON FILE APPROVED BY: Stephen Cuppan DATE: 10-16-2019TITLE: Engineering Supervisor

This permit shall be posted at the work site, and shall remain until the work is completed. It is subject to inspection at all times.

FOR INSPECTION ONLY A 24 HOUR
NOTICE IS REQUIRED AND THE
CONTRACTOR/APPLICANT IS
REQUIRED TO NOTIFY THE D.P.I.
@ 508 979-1550 Press 4 RepairROADWAY CLOSURES WILL REQUIRE
AUTHORIZATION FROM THE
COMMISSIONER OF PUBLIC
INFRASTRUCTURE. TRAFFIC MANAGEMENT
PLANS MAY BE REQUIRED.

PERMIT EXPIRES 1 YEAR

3 months

2763

1022

41' 1.0" ST 1928

41' 1.25" ST 1929

1026

PROPOSED WORK AREA

440' 4" CLIP 1919

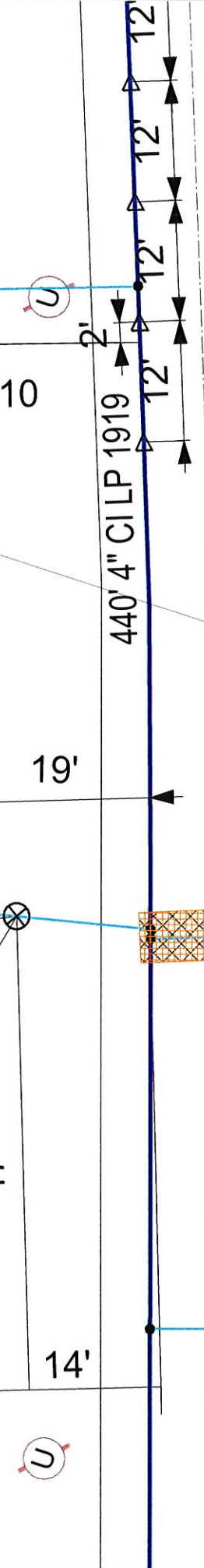

IMPORTANT - DO NOT SCALE

This drawing provides approximate locations only and all facility information may not be shown. Contact EVERSOURCE MA GAS to have specific field information identified. EVERSOURCE MA GAS disclaims any liability resulting from the reliance by any person on the location shown on this map. Massachusetts law requires that any person performing excavation work contact Dig-Safe so that the location of any underground may be marked.

Address: 1022 CHAFFEE ST WAL

City/Town: NEW BEDFORD 9/10/19

MASS LAW

Requires 72 hours advance notice of excavation before digging by anyone

Call Dig-Safe: 811

EVERSOURCE

EVERSOURCE MA GAS
One NSTAR Way
Westwood, MA 02090
Phone 1-800-592-2000