

APPLICATION/AGREEMENT
For Trench/Disturbance Permit within the City of New Bedford

Permit # 410-19.
Dig Safe#20193211371
Date: 08/08/19

TO THE MAYOR AND CITY COUNCIL: DISTURBANCE PERMIT/TRENCH SAFETY PERMIT

Permission is hereby requested to excavate the surface of : X City Property and/or X Private Property
Provide Sketch

Location of Work: 137 Smith St.
Cedar St. - Spruce St.

Gas Line Maintenance

Work will begin (weather permitting) on: August 22, 2019

Applicant Name: Robert Conklin Robert Conklin (SS) Excavator(s) Name: _____

Company Name: Eversource Hoisting Equipment License Number: _____
Grade: _____ Expiration Date: _____

Contact Number: 508-441-5813 Name & Contact Number of Insurer: _____

Competent Person on Work Site: ON FILE

APPROVED BY: Stephen Cuyler DATE: 9-18-2019
TITLE: Engineering Supervisor

This permit shall be posted at the work site, and shall remain until the work is completed. It is subject to inspection at all times.

HMA PATCH REPAIR: Due to new M¹⁰ street of 2018, the trench patch will require curb to curb \pm joint of new pavement to easterly line of work trench.

Wo. # 893325

23' 2.0" PL 1990

1" CILP 1901

137

SMITH ST

PROPOSED WORK AREA

20' 4.00" PY LP 2005

PY LP 2005

RAISE BOX 25'

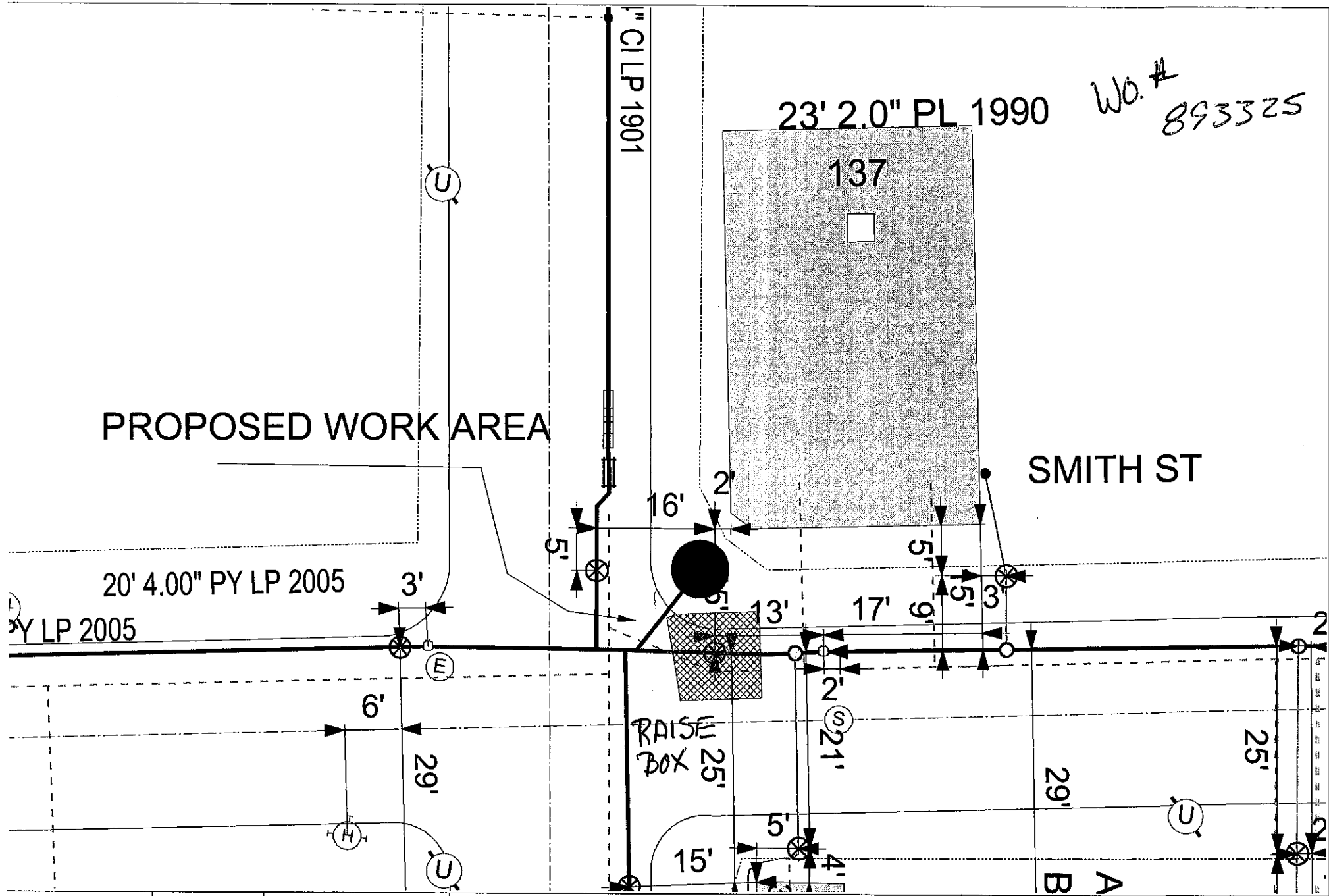

EVERSOURCE



MASS LAW

Requires 72 hours advance notice to Utility Companies before digging by Anyone

Call Dig-Safe: 811

IMPORTANT - DO NOT SCALE

This drawing provides approximate locations only and all facility information may not be shown. Contact EVERSOURCE MA GAS to have specific field information identified. EVERSOURCE MA GAS disclaims any liability resulting from the reliance by any person on the location shown on this map. Massachusetts law requires that any person performing excavation work contact Dig-Safe so that the location of any underground may be marked.

EVERSOURCE MA GAS
One NSTAR Way
Westwood, MA 02090
Phone 1-800-592-2000

Address: 137 Smith St SP

City/Town: New Bedford 6/20/2019