

## APPLICATION/AGREEMENT

Permit # 349-19

For Trench/Disturbance Permit within the City of New Bedford

Dig Safe#20193010040

Date: 07/25/19

TO THE MAYOR AND CITY COUNCIL:

DISTURBANCE PERMIT/TRENCH SAFETY PERMIT

Permission is hereby requested to excavate the surface of : X City Property and/or X Private Property

Provide Sketch

Location of Work: 936 Brock Ave.Ruth St. -Gas Service Cut OffWork will begin (weather permitting) on: August 8, 2019Applicant Name: Robert Conklin Excavator(s) Name: \_\_\_\_\_Company Name: Eversource

Hoisting Equipment License Number: \_\_\_\_\_

Grade: \_\_\_\_\_ Expiration Date: \_\_\_\_\_

Contact Number: 508-441-5817

Name &amp; Contact Number of Insurer: \_\_\_\_\_

Competent Person on Work Site: ON FILEAPPROVED BY: Stephen Cupreau DATE: 8-5-2019TITLE: Engineering Supervisor

This permit shall be posted at the work site, and shall remain until the work is completed. It is subject to inspection at all times.

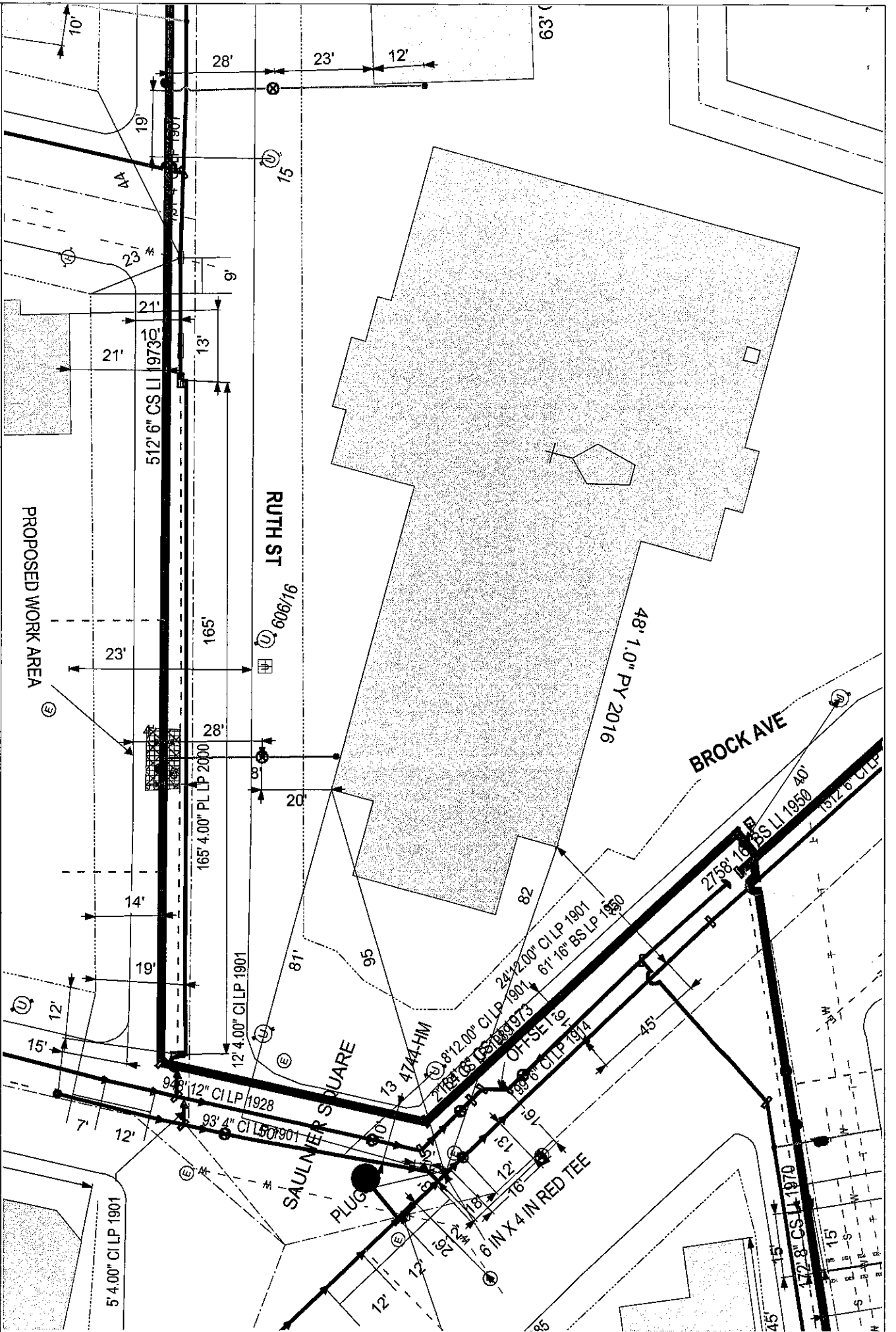

**EVERSOURCE**  
 EVERSOURCE MA GAS  
 One Market Way  
 Boston, MA 02109  
 Phone 1-800-592-2000



**MASS LAW**  
 Requires 72 hours advance  
 notice to utility companies  
 before digging by anyone  
**Call Dig-Safe: 811**

**IMPORTANT - DO NOT SCALE**  
 This drawing provides approximate locations only and all facility information  
 may not be shown. Contact EVERSOURCE MA GAS to have specific and  
 information identified. EVERSOURCE MA GAS disclaims any liability resulting from  
 the reliance by any person on the location shown on this map. Massachusetts  
 law requires that any person performing excavation work contact Dig-Safe so  
 that the location of any underground may be marked.

**Address:** 936 BROCK AVE WAL  
**City/Town:** NEW BEDFORD 7/24/19