

APPLICATION / AGREEMENT

For DISTURBANCE PERMIT within the City of New Bedford

This permit shall be posted at the work site, and shall remain until the work is completed. It is subject to inspection at all times.

TO THE MAYOR AND CITY COUNCIL: 1 DISTURBANCE PERMIT

Permission is hereby requested to excavate the surface of: 1 City Property

Location of work: 75 Macarthur drive

Substantially as per plan annexed, for the purpose of: Installation of Electric manhole and conduit

Work will begin (weather permitting) on: 5-31-19

Work will end (weather permitting) on: 6-30-19

Applicant Name: Frank Corp./Franklin Utility

Company Name: Frank Corp./Franklin Utility

Excavator(s) Name: Rich Franklin H/E-076597

Hoisting Equipment License Number: Smithwick & Mariners

Grade: 2A Expiration Date: 9-6-20

Contact Name: Name & Contact Number of Insurer: 508-995-9997

Approved By: Manuel H. Silva Date: 5/30/2019

Title: Deputy Commissioner

Roadway closures will require authorization from the Commissioner of Public Infrastructure.
Traffic management plans may be required.
On inspection, 24-hour notice is required and the contractor/Applicant is required to
notify the DPJ at 508-972-1550 for repair. Permit Expires in 3 Months from work start date.

Provide Sketch

Attached







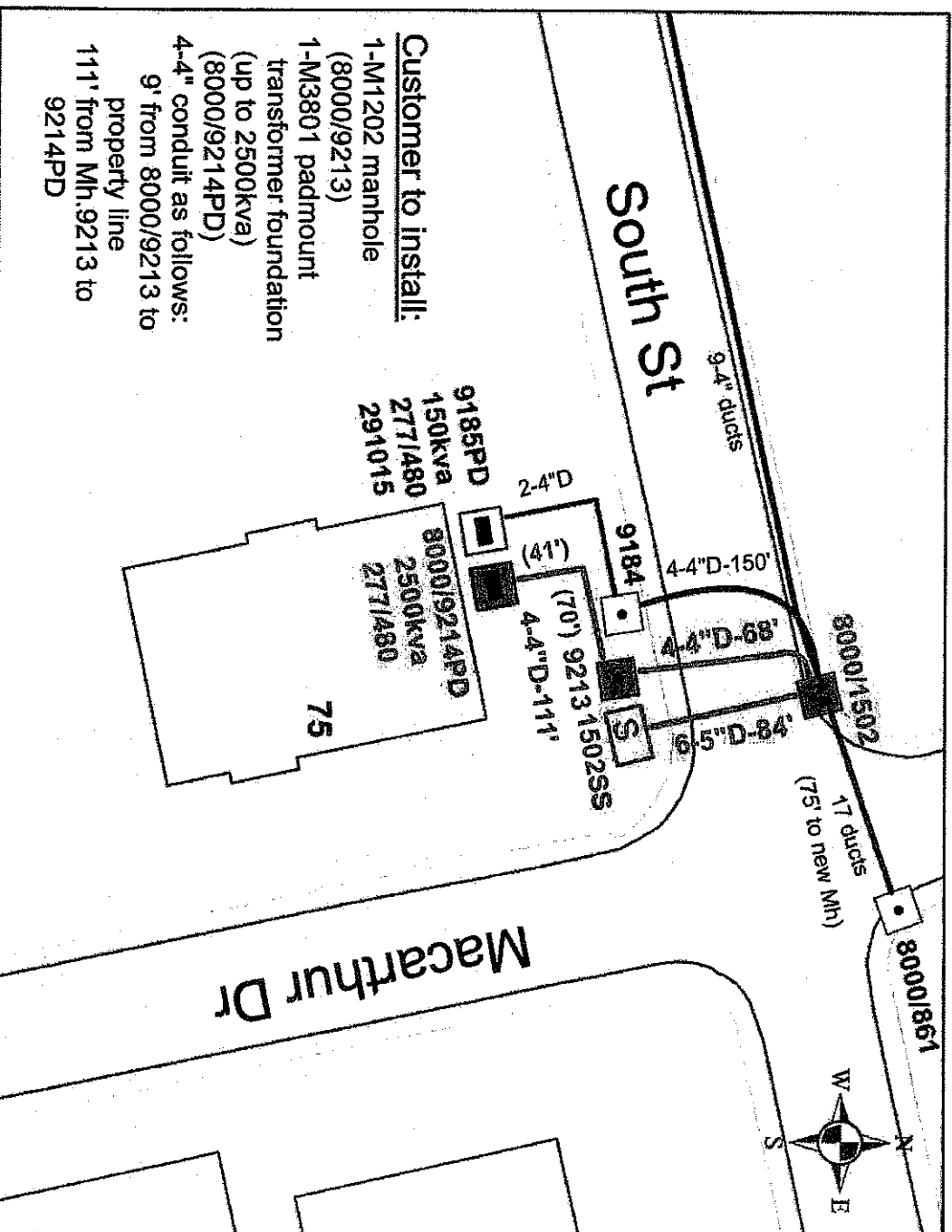

Permit # 287-19

Dig Safe # 20192010656

Date Issued: May 30, 2019

Service Address:	75 Macarthur Dr	City:	New Bedford	Page Number:	1 of 4 Pages	Auth. No.	2308354	Work Order Number:
Customer's Name/Title:	Streetside Realty LLC		Prepared by:	A. Magalhaes		Date		
Sales Representative:	Charlie Tavares		Eversource contractor to install: 1-M1203 manhole (6'x10'x6'), 1-PME-9 foundation, 4-4" duct from Mh. 1502 to property line(59') & 6-5" duct from Mh. 1502 to 1502SS-84'.			Circuit Number:	19 (7620/13.2)	
Electrician:						T.L.M.:		
Switch Size:						Secondary Sheet Number:		

**Key:**

-  -existing manhole
-  -existing padmount transformer
-  -existing conduit
-  -M1202 manhole (4'x6'x6')
-  -M3801 padmount transformer foundation (up to 2500kva)
-  -PME-9 foundation
-  -conduit
-  -M1203 manhole (6'x10'x6')

Customer to install:

- 1-M1202 manhole (8000/9213)
- 1-M3801 padmount transformer foundation (up to 2500kva) (8000/9214PD)
- 4-4" conduit as follows:
9' from 8000/9213 to property line
- 111' from Mh. 9213 to 9214PD