

APPLICATION / AGREEMENT  
For DISTURBANCE PERMIT within the City of New Bedford

Permit # 223-19.  
Dig Safe # 2019-1206636  
Date Issued: April 03, 2019

This permit shall be posted at the work site, and shall remain until the work is completed. It is subject to inspection at all times.

TO THE MAYOR AND CITY COUNCIL: 1 DISTURBANCE PERMIT

Permission is hereby requested to excavate the surface of: 1 City Property

Location of work: 403 Valley Road

Substantially as per plan annexed, for the purpose of: hole excavation for Everource

Work will begin (weather permitting) on: 4/23/19

Work will end (weather permitting) on: 4/23/19

Applicant Name: [Signature]

Excavator(s) Name: [Signature]

Company Name: MSR Utility Maintenance

Hoisting Equipment License Number: \_\_\_\_\_

Grade: \_\_\_\_\_

Expiration Date: \_\_\_\_\_

Contact Name: [Signature]

Name & Contact Number of Insurer: \_\_\_\_\_

**Frances Provencher**

Approved By: [Signature]

Date: 4/3/19

Title: Admin Manager

Roadway closures will require authorization from the Commissioner of Public Infrastructure.  
Traffic management plans may be required.  
For inspection, 24 hour notice is required and the Contractor, Applicant, is required to  
notify the D.P.I. @ 508-979-1550, Press 4, Repair. Permit Expires In 3 Months from work start date.

Provide Sketch

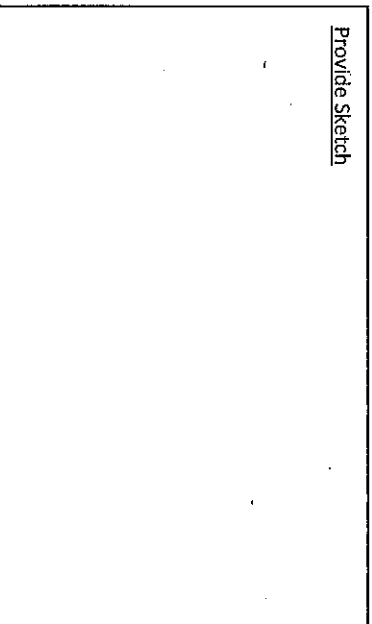

(1) 2'x2'

Service

PREMARK FORM

permit required

Circle One

National grid

Liberty Utilities

Unitil

Eversource

Columbia Gas

403  
Location Valley Rd, New Bedford

Cross St # 1 Phillips Rd

Cross St # 2 Pine Hill Dr

Premark Date 3/14/19

Foreman Name PG

Digsafe # 20191206636

Date: 3/25/19 9AM

Picture # \_\_\_\_\_

Circle all that apply

Private Property: Y or N Pavement to be broken: Y or N

Sidewalk / Street / Grass / Driveway

Permit Y or N

Police Detail Needed: Y or N

State Rd : Y or N

Guaranteed Road: Y or N What Year? \_\_\_\_\_

Draw Sketch Below

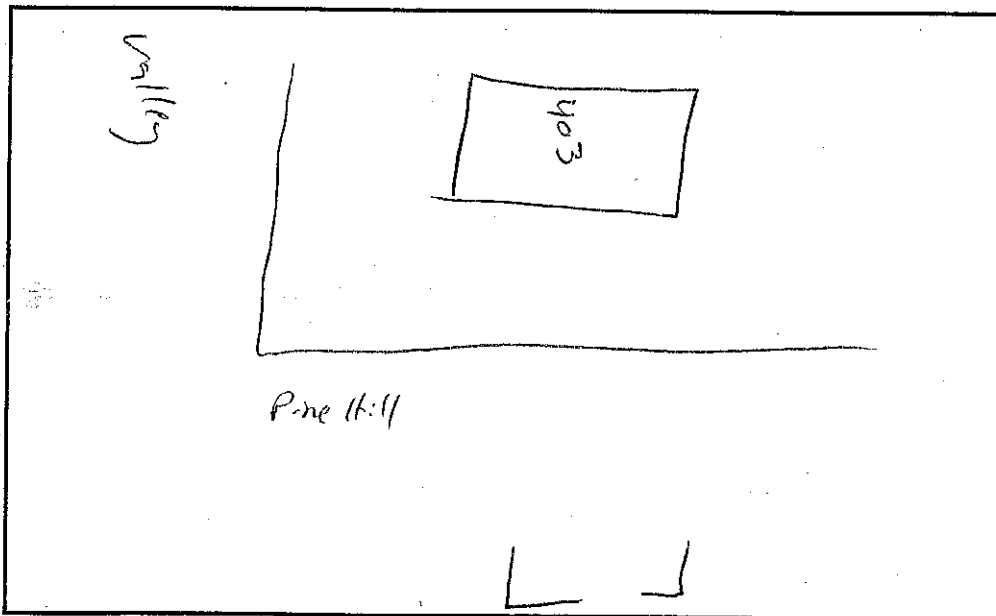

<b>Request Number:</b> 20191206636 <b>Date:</b> 03/20/2019 <b>Time:</b> 09:00		
<b>Latitude:</b> <b>Longitude:</b>		
<b>State:</b> MASSACHUSETTS <b>Municipality:</b> NEW BEDFORD		
<b>Address / Intersection:</b> 403 VALLEY RD		
<b>Nearest Cross Street 1:</b> PHILLIPS RD <b>Nearest Cross Street 2:</b> PINE HILL DR		
<b>Additional Information:</b>		
<b>Nature Of Work:</b> INSPECT, RECENTLY INSTALLED GAS MAIN/SERVICE		
<b>Area Of Work:</b> WORKING IN THE EXISTING GAS TRENCH IN FRONT OF BUILDING #403		
<b>Area Is Premarked:</b> Y <b>Start Date:</b> 03/25/2019 <b>Start Time:</b> 09:00		
<b>Caller:</b> AMY ANDERSON <b>Title:</b> CLERK <b>Return Call:</b> ANYTIME		
<b>Phone#:</b> 978-649-0002 <b>Fax#:</b> 9786490002 <b>Alt. Phone#:</b>		
<b>Email Address:</b> MSRUTILITY427@GMAIL.COM		
<b>Contractor:</b> MSR UTILITY MAINTENANCE CORP		
<b>Address:</b> 209 PLEASANT ST <b>City:</b> DUNSTABLE <b>State:</b> MA <b>Zip:</b> 01827		
<b>Excavator Doing Work:</b> MSR UTILITY MAINTENANCE CORP		
<b>Member Utility List</b>		
<b>Code</b>	<b>Abbreviation</b>	<b>Name</b>
CN	NSTREL	EVERSOURCE - ELECTRIC
CP	NSTGAS	NSTAR GAS
HK	COMCAS	COMCAST - PEMBROKE

- There may be non-member utilities in the area that you need to notify.
- Electric and other companies may not mark lines they don't own or maintain. You may want to contact them for more information.
- The excavator is responsible to maintain markings placed by member utilities.
- You are required by law to call 911 if pipeline damage results in a gas release.

**DIG SAFE ENCOURAGES A COPY OF THIS ELECTRONIC TICKET ON SITE AT ALL TIMES.**

[Create New](#)
[Create From Existing](#)
[Print Ticket](#)
[Return To Menu](#)
[Return To Home](#)

