

APPLICATION/AGREEMENT

For Trench/Disturbance Permit within the City of New Bedford

Permit # 196-19
Dig Safe#20190801800
Date: 02/20/19Electric over

TO THE MAYOR AND CITY COUNCIL: DISTURBANCE PERMIT/TRENCH SAFETY PERMIT

Permission is hereby requested to excavate the surface of: X City Property and/or X Private Property
Provide SketchLocation of Work: 211 Church St. - P107 L28
Glennon St. - Query St.
Relay Gas ServiceWork will begin (weather permitting) on: March 6, 2019Applicant Name: Robert Conklin Robert Conklin Excavator(s) Name: _____Company Name: Eversource

Hoisting Equipment License Number: _____

Grade: _____ Expiration Date: _____

Contact Number: 508-441-5817

Name & Contact Number of Insurer: _____

Competent Person on Work Site: ON FILEAPPROVED BY: Adam G. G. G. DATE: 2-25-19TITLE: Sup. Civil Engineer

This permit shall be posted at the work site, and shall remain until the work is completed. It is subject to inspection at all times.

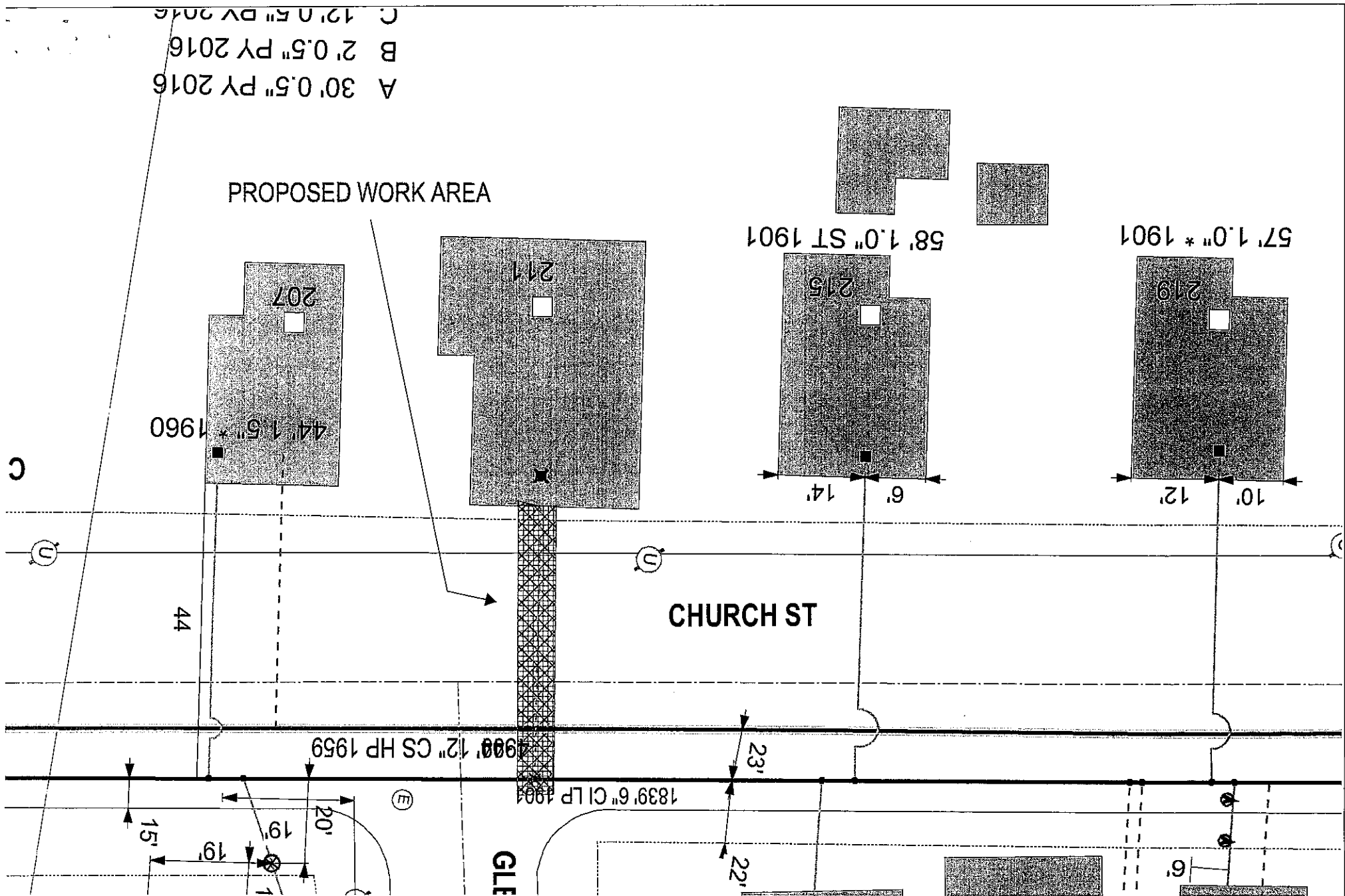

| | | | | |
|---|--|---|---|---|
| <p>EVERSOURCE</p> <p>EVERSOURCE MA GAS One NSTAR Way Westwood, MA 02090 Phone 1-800-592-2000</p> | | <p>MASS LAW Requires 72 hours advance notice to Utility Companies before digging by Anyone</p> <p>Call Dig-Safe: 811</p> | <p>IMPORTANT - DO NOT SCALE</p> <p>This drawing provides approximate locations only and all facility information may not be shown. Contact EVERSOURCE MA GAS to have specific field information identified. EVERSOURCE MA GAS disclaims any liability resulting from the reliance by any person on the location shown on this map. Massachusetts law requires that any person performing excavation work contact Dig-Safe so that the location of any underground may be marked.</p> | <p>Address: 211 Church St WAL</p> <p>City/Town: New Bedford 2/19/19</p> |
|---|--|---|---|---|