



CITY OF NEW BEDFORD

MASSACHUSETTS

ENGINEERING - 508-979-1550

PH 1
APPLICATION FOR
CONSTRUCTION OF
PAVED
SIDEWALK / DRIVEWAY

RECEIVED
APR 13 2017
BY: JS

Expires: 4/11/2018

Application No. 11,325

Date: 4/11/2017

Property Owner: Mareo Silva

Tel: (508) 728-1662

Address: 78 Moorings Rd Marion MA 02738
street city state zip code

The above hereby requests permission to construct a paved: _____ driveway / _____ sidewalk located at
Chaple St (W's) 82' W x Church St., plot 1306, lot 22 in accordance with the
terms and conditions set forth herein, and the Ordinances of the City of New Bedford.

Sidewalk	Dimensions	Driveway	Width (ft)
Bituminous Concrete	_____	Residential	_____
Concrete Full Width	_____	<input checked="" type="checkbox"/> Commercial	_____
Concrete Ribbon	_____	Relocation/Widening	_____
Curb Needed	_____	Curb Removal	<u>N/A</u>
	_____	Concrete	<u>22' x 6'</u>
	_____	Bituminous Concrete	_____

Bonded Contractor: Paving Tel: _____

Traffic Commission: Approved 5/31/17 Date _____
Signature _____

Building Dept. Signature _____
Approved (New Building) _____
Approved - Bldg. Permit# _____
Rejected _____

Signature _____
Engineering Department Approved 5/31 Date _____
Signature Robert Bickel (MS)

Permit/Inspection fee of \$150.00 must accompany this application.
Contractor to call 24 hrs. in advance for pre-inspection (prior to pouring)
SPECIAL REQUIREMENTS: If curbing is removed, it must be returned within 24 hrs to the D.P.I. Yard
1105 Shawmut Ave., New Bedford

PAID: 150.

Robert Bickel
Supervising Civil Engineer (MS)
BY: Chavell Torres Chavell Torres
Property Owner

Clearly identified by a sign
rved for physically handicapped

A 2 FT X 4 FT YELLOW DETECTABLE
H 28 CFR PART 36, SECTION 4.29 IN
IN CHURCH STREET AND AT END OF
RES.

L BE ARRANGED AND SHIELDED SO AS
FROM THE LIGHT SOURCE ONTO ANY
PROPERTY. ALL PARKING FACILITIES
SHALL BE LIGHTED AS EVENLY AND
HE MAXIMUM WATTAGE LIMITS
BUILDING CODE.

D SIDEWALKS, DRIVEWAYS, DRAINAGE
ED FROM THE DEPARTMENT OF PUBLIC
ING DIVISION. THE DRIVEWAY PERMIT
THE NEW BEDFORD TRAFFIC
SHALL ABIDE BY ALL CONDITIONS OF
AFFIC COMMISSION.

TO BE BUILT IN ACCORDANCE WITH
LATIONS WITH A 4-FOOT GRANITE
ST SIDE IN CHAFFEE STREET. A
N CURB SHALL BE INSTALLED ON
AT THE PROPERTY LINE.

ICRETE SIDEWALK SHALL BE INSTALLED
HURCH STREET. A NEW GRANITE CURB
THE FRONTAGE IN CHAFFEE STREET.
TRANSITION CURB AT THE NORTHERLY
A STREET).

ER) SHALL BE INSTALLED 1.5 FEET
CHAFFEE STREET.

R SHOULD BE INSTALLED AT 2%
BEND DOWN TO THE SEWER MAIN IN

150i; MANUFACTURED BY RINKER
AD WESTFIELD, AM 01085
ED COMPARABLE SUBSTITUTE.

VE AND SITE CONTRACTOR MUST
NON MEETING WITH THE DEPARTMENT
- ENGINEERING DIVISION PRIOR TO
I AND PROVIDE A FULL SET OF THE
HE SITE CONSTRUCTION PLANS.

NBDPI TO ASSIGN A NEW ADDRESS
.

SITE WORK, THE PROJECT ENGINEER
/INGS IN AUTOCAD FORMAT PRIOR TO
BEING ISSUED.

MAP 130G-1
LOT 26

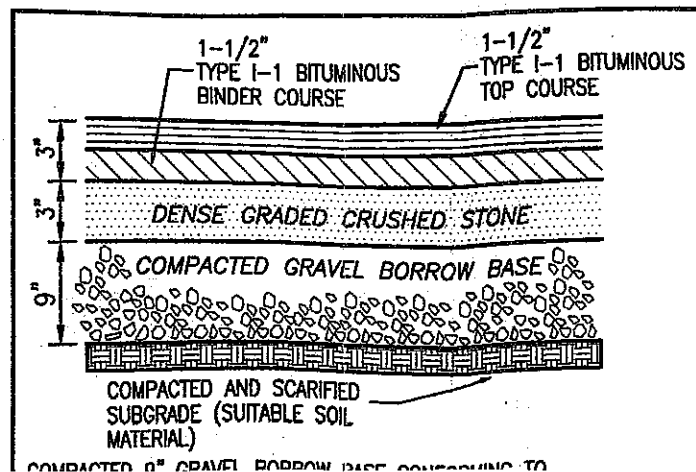
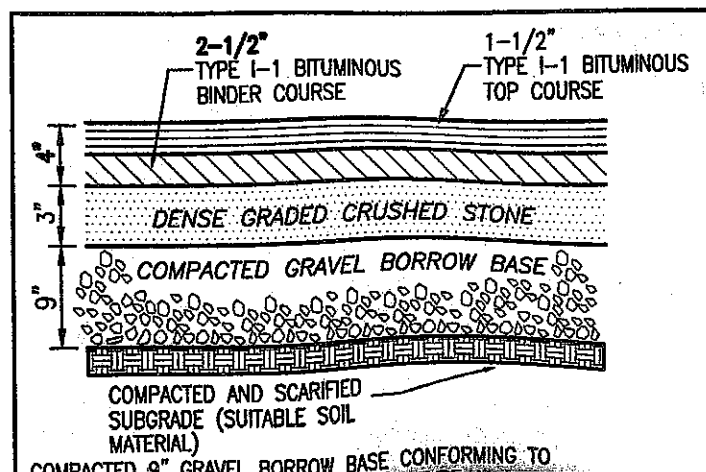
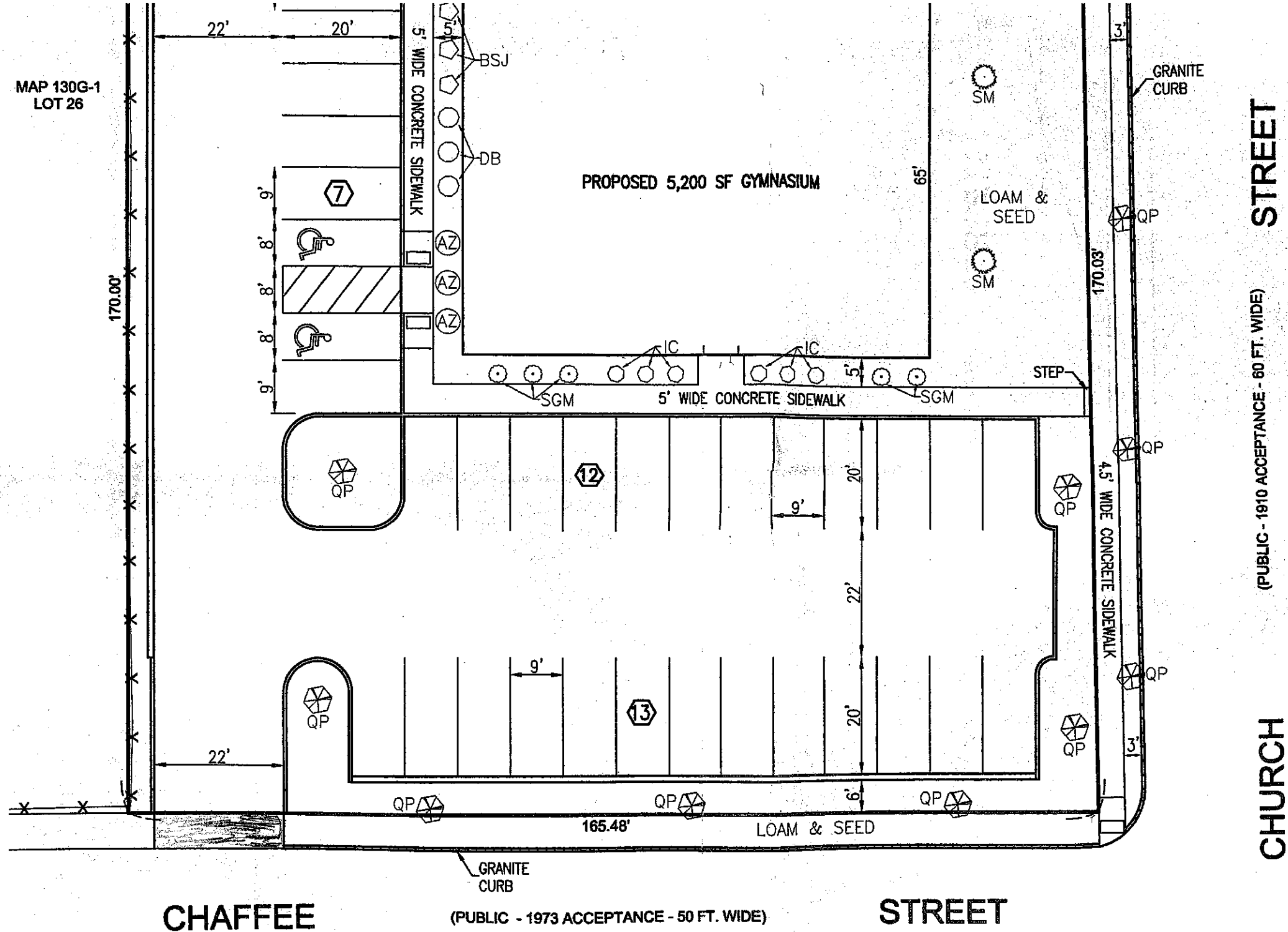

ALAN J. HEUREUX, P.E.
MA. REG. NO. 33811

LAYOUT & LAND
XCEL BRAZILIAN
MAP 130G-1, FORMERLY
NEW BEDFORD, MAS
PREPARED F

MARCIO S

SCALE: 1"=20' DATE:
REVISED: MARCH 2, 2017

PREPARED E

Boucher & He

CIVIL ENGINEERS

648 AMERICAN LEGION HIC