

APPLICATION/AGREEMENT
For Trench/Disturbance Permit within the City of New Bedford

Permit # 79-16
Dig Safe#20161005554
Date 3/10/16

MAR 10 2016

TO THE MAYOR AND CITY COUNCIL:

DISTURBANCE PERMIT/TRENCH SAFETY PERMIT

Permission is hereby requested to excavate the surface of: X City Property and/or X Private Property
Provide Sketch

Location of Work: 662-676 S-1st St.
Delano St. - Blackmer St.

Gas Line Maintenance

Work will begin (weather permitting) on: March 24, 2016

Work will end (weather permitting) on: 60 days

Applicant Name: Craig A. Mello *(Signature)*

Company Name: Eversource

Contact Number: 508-441-5809

Competent Person on Work Site: ON FILE

ROADWAY CLOSURES WILL REQUIRE
AUTHORIZATION FROM THE
COMMISSIONER OF PUBLIC
INFRASTRUCTURE, TRAFFIC MANAGEMENT
PLANS MAY BE REQUIRED.

FOR INSPECTION ONLY A 24 HOUR
NOTICE IS REQUIRED AND THE
CONTRACTOR/APPLICANT IS
REQUIRED TO NOTIFY THE D.P.I.
@ 508 979-1550 Press 3 Repair

Excavator(s) Name: _____

Hoisting Equipment License Number: _____
Grade: _____ Expiration Date: _____

Name & Contact Number of Insurer: _____

APPROVED BY: Manuel H. Silva DATE: 3/16/2016

TITLE: Supervising Civil Engineer

This permit shall be posted at the work site, and shall remain until the work is completed. It is subject to inspection at all times.

6526 / 2

✓

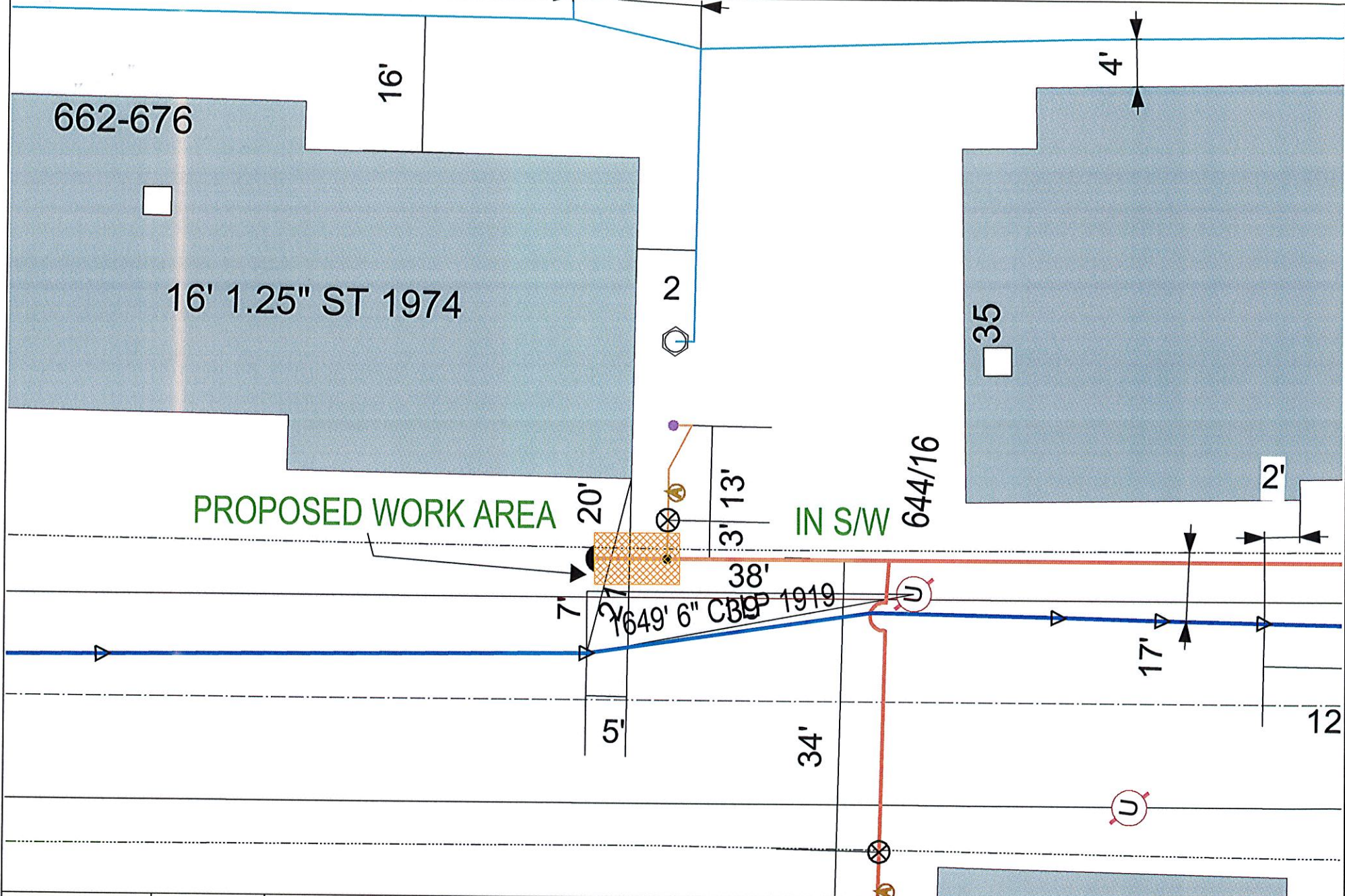

<p>EVERSOURCE</p> <p>EVERSOURCE MA GAS One NSTAR Way Westwood, MA 02090 Phone 1-800-592-2000</p>		<p>MASS LAW Requires 72 hours advance notice to Utility Companies before digging by Anyone</p> <p>Call Dig-Safe: 811</p>	<p>IMPORTANT - DO NOT SCALE</p> <p>This drawing provides approximate locations only and all facility information may not be shown. Contact EVERSOURCE MA GAS to have specific field information identified. EVERSOURCE MA GAS disclaims any liability resulting from the reliance by any person on the location shown on this map. Massachusetts law requires that any person performing excavation work contact Dig-Safe so that the location of any underground may be marked.</p>	<p>Address: 662-676 S FIRST ST WL</p> <p>City/Town: NEW BEDFORD 3/7/16</p>
---	--	---	---	--