

APPLICATION/AGREEMENT  
For Trench/Disturbance Permit within the City of New Bedford  
MAR 07 2016

Permit # 72-16  
Dig Safe#20160901358  
Date 02/29/16

TO THE MAYOR AND CITY COUNCIL: DISTURBANCE PERMIT/TRENCH SAFETY PERMIT

Permission is hereby requested to excavate the surface of: X City Property and/or X Private Property  
Provide Sketch

Location of Work: Cove St.  
Viall St.

Gas Line Maintenance

Work will begin (weather permitting) on: March 14, 2016

Work will end (weather permitting) on: 60 days

FOR INSPECTION ONLY A 24 HOUR  
NOTICE IS REQUIRED AND THE  
CONTRACTOR/APPLICANT IS  
REQUIRED TO NOTIFY THE D.P.I.  
@ 508 979-1550 Press 3 Repair

ROADWAY CLOSURES WILL REQUIRE  
AUTHORIZATION FROM THE  
COMMISSIONER OF PUBLIC  
INFRASTRUCTURE. TRAFFIC MANAGEMENT  
PLANS MAY BE REQUIRED.

Applicant Name: Craig A. Mello Craig A. Mello (SS) Excavator(s) Name: \_\_\_\_\_

Company Name: Eversource Hoisting Equipment License Number: \_\_\_\_\_  
Grade: \_\_\_\_\_ Expiration Date: \_\_\_\_\_

Contact Number: 508-441-5813 Name & Contact Number of Insurer: \_\_\_\_\_

Competent Person on Work Site: ON FILE

APPROVED BY: Manuel H. Silva DATE: 3/7/2016  
TITLE: Supervising Civil Engineer

This permit shall be posted at the work site, and shall remain until the work is completed. It is subject to inspection at all times.



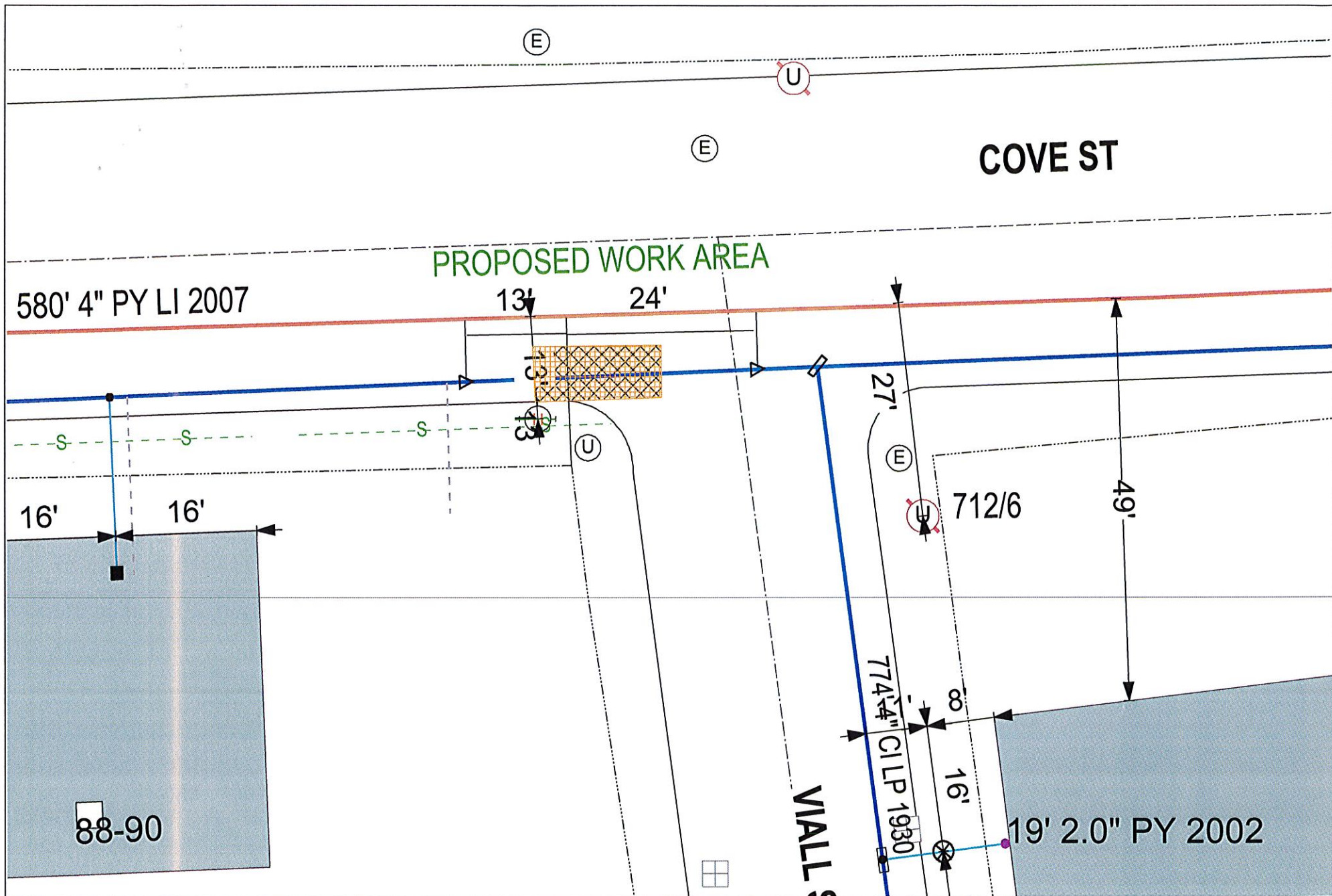

**EVERSOURCE**

EVERSOURCE MA GAS  
One NSTAR Way  
Westwood, MA 02090  
Phone 1-800-592-2000



**MASS LAW**  
Requires 72 hours advance  
notice to Utility Companies  
before digging by Anyone

Call Dig-Safe: 811

**IMPORTANT - DO NOT SCALE**

This drawing provides approximate locations only and all facility information may not be shown. Contact EVERSOURCE MA GAS to have specific field information identified. EVERSOURCE MA GAS disclaims any liability resulting from the reliance by any person on the location shown on this map. Massachusetts law requires that any person performing excavation work contact Dig-Safe so that the location of any underground may be marked.

Address: Cove St & Vail St CAD

City/Town: New Bedford 2/26/26