

APPLICATION/AGREEMENT

For Trench/Disturbance Permit within the City of New Bedford

Permit # 70-16
Dig Safe#20160902029
Date 3/1/16

TO THE MAYOR AND CITY COUNCIL: DISTURBANCE PERMIT/TRENCH SAFETY PERMIT

6501.01 / 3

Permission is hereby requested to excavate the surface of: X City Property and/or X Private Property
Provide Sketch

Location of Work: Bristol St.

Int. w/Acushnet Ave & end at 913 Bristol St.

Relay Gas Main & Services

Work will begin (weather permitting) on: March 15, 2016ROADWAY CLOSURES WILL REQUIRE
AUTHORIZATION FROM THE
COMMISSIONER OF PUBLIC
INFRASTRUCTURE. TRAFFIC MANAGEMENT
PLANS MAY BE REQUIRED.FOR INSPECTION ONLY A 24 HOUR
NOTICE IS REQUIRED AND THE
CONTRACTOR/APPLICANT IS
REQUIRED TO NOTIFY THE D.P.I.
@ 508 979-1550 Press 3 RepairWork will end (weather permitting) on: 60 daysApplicant Name: Craig A. Mello Craig A. Mello (ra) Excavator(s) Name: _____Company Name: Eversource Hoisting Equipment License Number: _____
Grade: _____ Expiration Date: _____Contact Number: 508-441-5809 Name & Contact Number of Insurer: _____Competent Person on Work Site: ON FILEAPPROVED BY: Manuel H. Silva DATE: 3/7/2016
TITLE: Supervising Civil Engineer

This permit shall be posted at the work site, and shall remain until the work is completed. It is subject to inspection at all times.

Patch : Center of roadway to curb line.

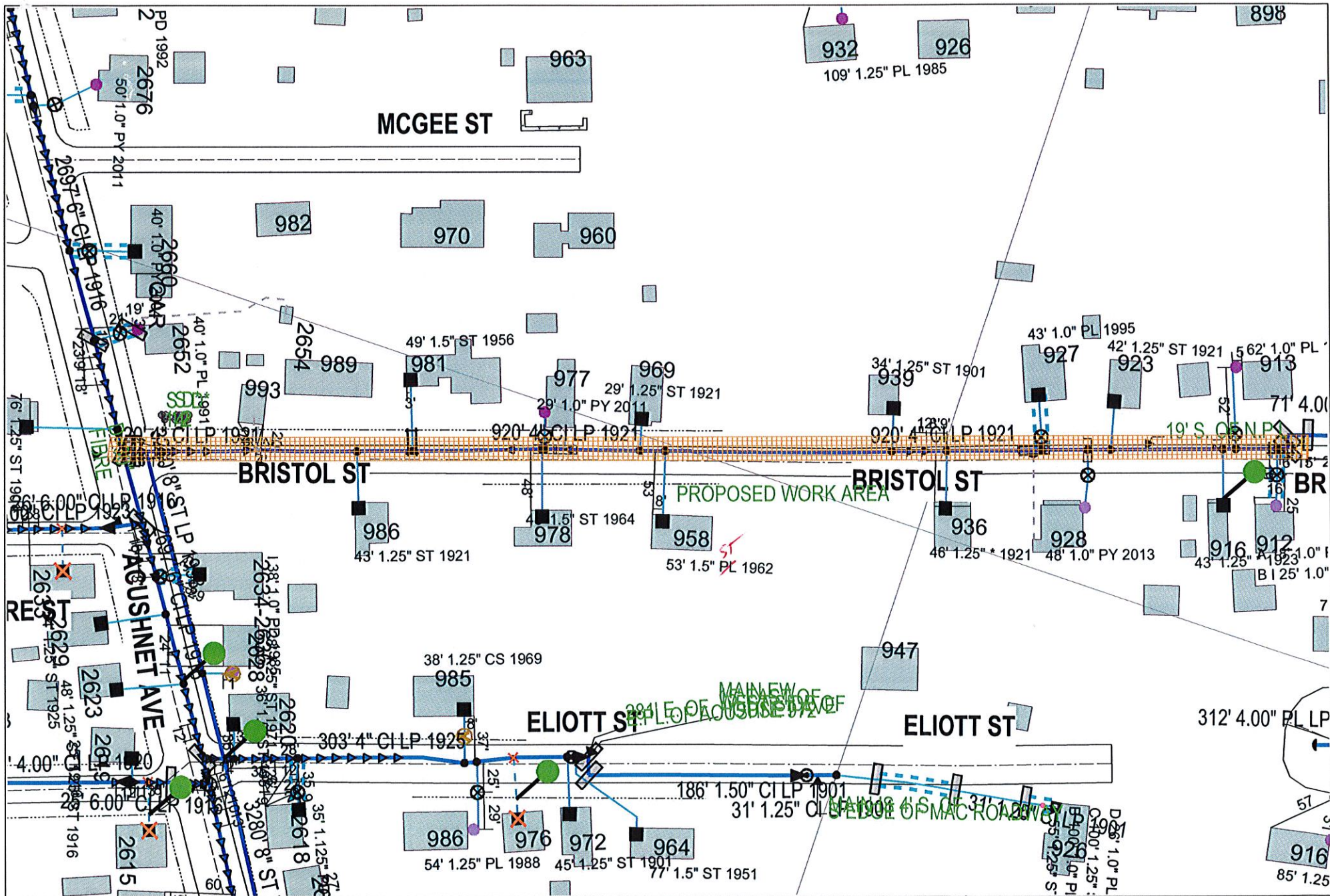

EVERSOURCE

EVERSOURCE MA GAS
One NSTAR Way
Westwood, MA 02090
Phone 1-800-892-2000



MASS LAW
Requires 72 hours advance
notice to Utility Companies
before digging by Anyone

Call Dig-Safe: 811

IMPORTANT - DO NOT SCALE

This drawing provides approximate locations only and all facility information may not be shown. Contact EVERSOURCE MA GAS to have specific field information identified. EVERSOURCE MA GAS disclaims any liability resulting from the reliance by any person on the location shown on this map. Massachusetts law requires that any person performing excavation work contact Dig-Safe so that the location of any underground may be marked.

Address: **Bristol St CAD**

City/Town: **New Bedford 2/22/16**