

APPLICATION/AGREEMENT

For Trench/Disturbance Permit within the City of New Bedford

Permit # 68-16
Dig Safe#20160902022&
20160902006 Date 3/1/16

TO THE MAYOR AND CITY COUNCIL:

DISTURBANCE PERMIT/TRENCH SAFETY PERMIT

Permission is hereby requested to excavate the surface of: X City Property and/or X Private Property
Provide Sketch

Location of Work: 26 Madeira Ave.
Hathaway St. - Earle St.

Install Gas Service

Work will begin (weather permitting) on: March 15, 2016

ROADWAY CLOSURES WILL REQUIRE
AUTHORIZATION FROM THE
COMMISSIONER OF PUBLIC
INFRASTRUCTURE. TRAFFIC MANAGEMENT
PLANS MAY BE REQUIRED.

FOR INSPECTION ONLY A 24 HOUR
NOTICE IS REQUIRED AND THE
CONTRACTOR/APPLICANT IS
REQUIRED TO NOTIFY THE D.P.I.
@ 508 979-1550 Press 3 Repair

Work will end (weather permitting) on: 60 days

Applicant Name: Craig A. Mello

Excavator(s) Name: _____

Company Name: Eversource

Hoisting Equipment License Number: _____

Grade: _____ Expiration Date: _____

Contact Number: 508-441-5809

Name & Contact Number of Insurer: _____

Competent Person on Work Site: ON FILE

APPROVED BY: Manuel H. Silva DATE: 3/7/2016

TITLE: Supervising Civil Engineer

This permit shall be posted at the work site, and shall remain until the work is completed. It is subject to inspection at all times.

6506/3.



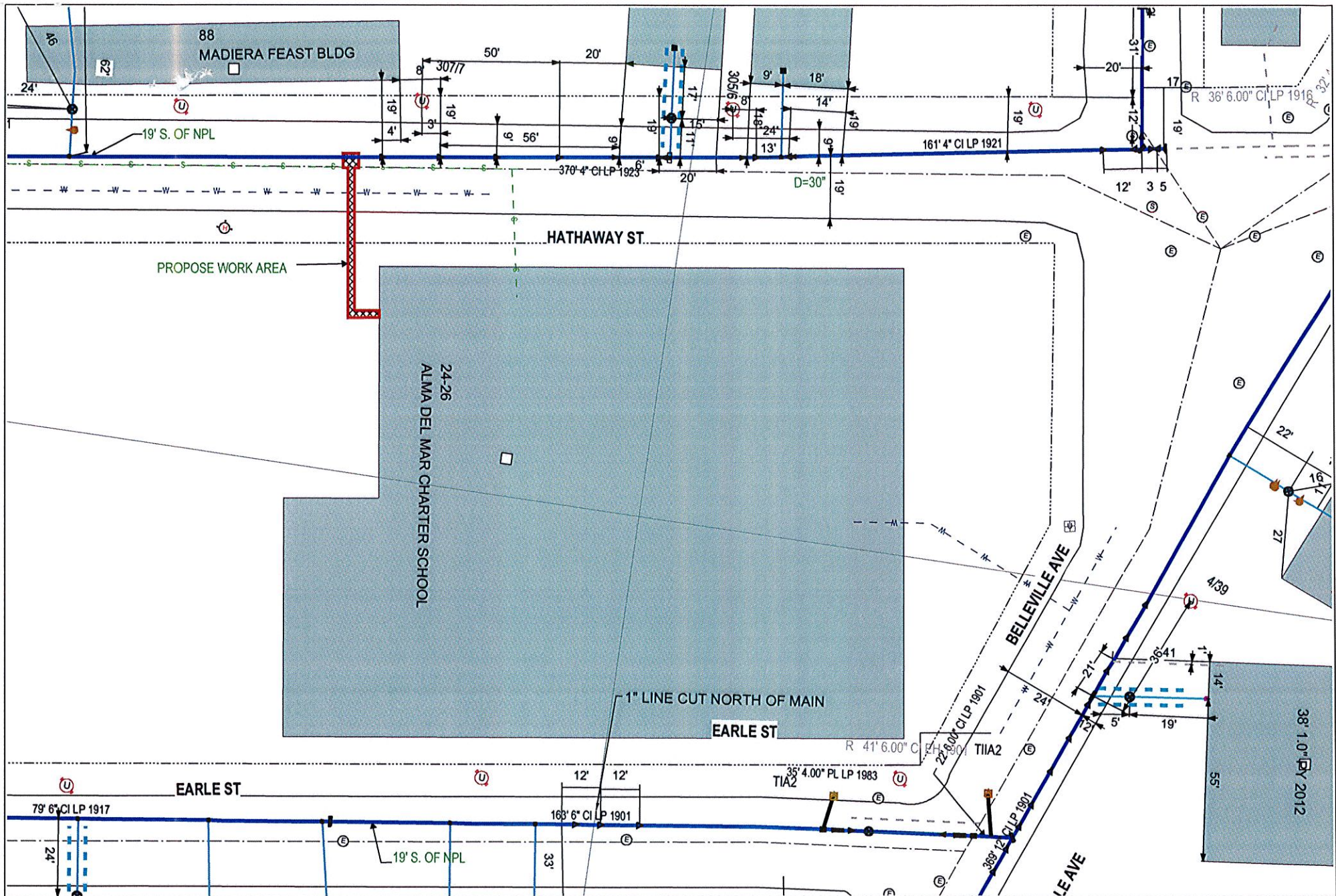

<p>EVERSOURCE</p> <p>EVERSOURCE MA GAS One NSTAR Way Westwood, MA 02090 Phone 1-800-592-2000</p>		<p>MASS LAW Requires 72 hours advance notice to Utility Companies before digging by Anyone</p> <p>Call Dig-Safe: 811</p>	<p>IMPORTANT - DO NOT SCALE</p> <p>This drawing provides approximate locations only and all facility information may not be shown. Contact EVERSOURCE MA GAS to have specific field information identified. EVERSOURCE MA GAS disclaims any liability resulting from the reliance by any person on the location shown on this map. Massachusetts law requires that any person performing excavation work contact Dig-Safe so that the location of any underground may be marked.</p>	<p>Address: 26 Madeira Ave BPD</p> <p>City/Town: New Bedford 2/25/16</p>
---	---	--	---	--