

Received  
For Trench/Disturbance Permit within the City of New Bedford  
NOV 3 2016

APPLICATION/AGREEMENT

Permit # 511-16  
Dig Safe#20164403700  
Date: 11/01/16

✓ 0501-3

TO THE MAYOR AND CITY COUNCIL: DISTURBANCE PERMIT/TRENCH SAFETY PERMIT

Public Infrastructure  
Permission is hereby requested to excavate the surface of: X City Property and/or X Private Property  
Provide Sketch

Location of Work: 136 Dartmouth St.  
Hickory St. - Oak St.  
Gas Line Maintenance

ROADWAY CLOSURES WILL REQUIRE  
AUTHORIZATION FROM THE  
COMMISSIONER OF PUBLIC  
INFRASTRUCTURE. TRAFFIC MANAGEMENT  
PLANS MAY BE REQUIRED.

Work will begin (weather permitting) on: November 15, 2016

Work will end (weather permitting) on: 60 days

FOR INSPECTION ONLY A 24 HOUR  
NOTICE IS REQUIRED AND THE  
CONTRACTOR/APPLICANT IS  
REQUIRED TO NOTIFY THE D.P.I.  
@ 508 979-1550 Press 3 Repair

Applicant Name: Craig A. Mello Craig A. Mello (CA) Excavator(s) Name: \_\_\_\_\_

Company Name: Eversource Hoisting Equipment License Number: \_\_\_\_\_  
Grade: \_\_\_\_\_ Expiration Date: \_\_\_\_\_

Contact Number: 508-441-5809 Name & Contact Number of Insurer: \_\_\_\_\_

Competent Person on Work Site: ON FILE

APPROVED BY: Manuel H. Silva DATE: 11/3/2016

TITLE: Deputy Commissioner

This permit shall be posted at the work site, and shall remain until the work is completed. It is subject to inspection at all times.

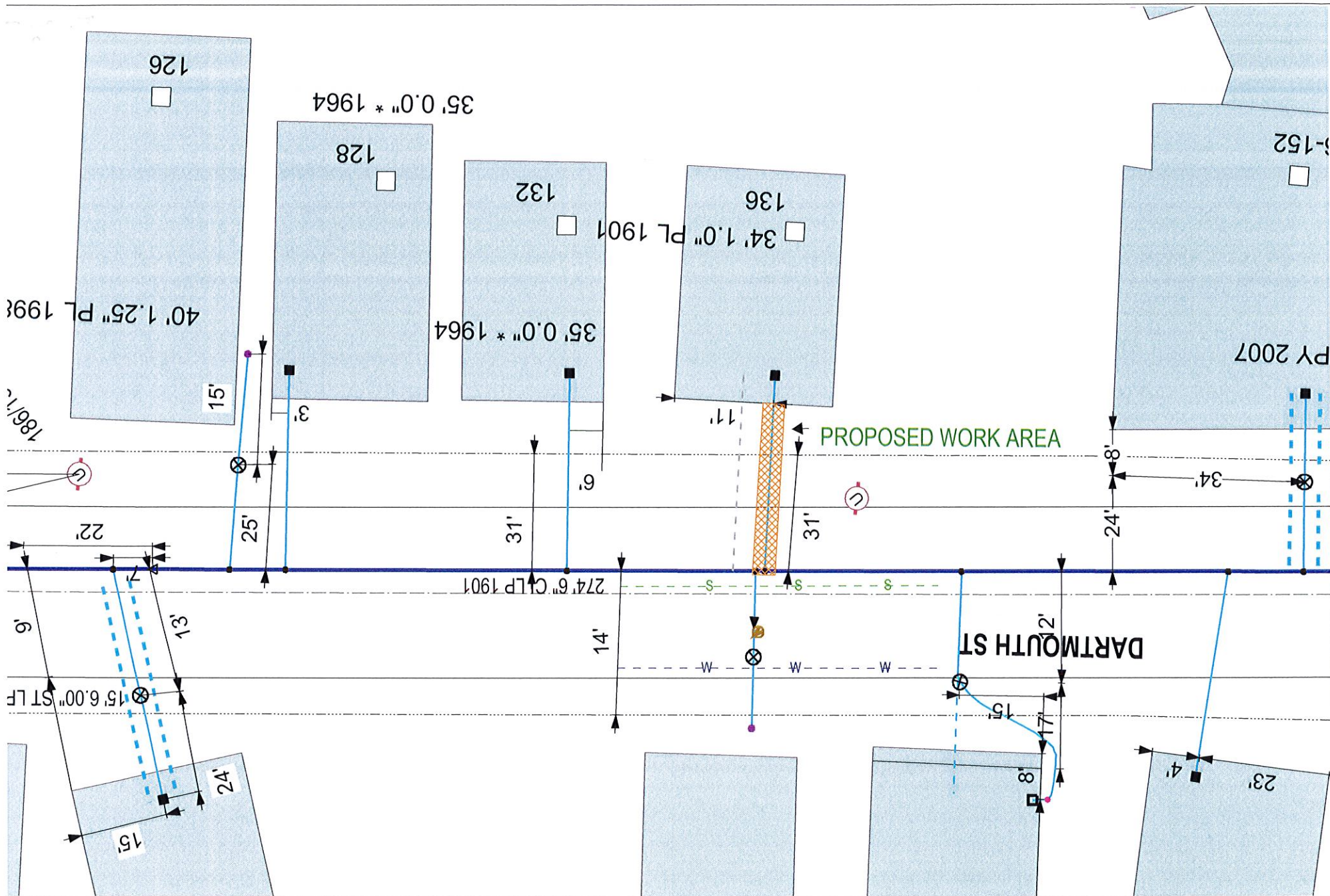

**EVERSOURCE**

EVERSOURCE MA GAS  
One NSTAR Way  
Westwood, MA 02090  
Phone 1-800-592-2000



**MASS LAW**  
Requires 72 hours advance  
notice to Utility Companies  
before digging by Anyone

Call Dig-Safe: 811

**IMPORTANT - DO NOT SCALE**

This drawing provides approximate locations only and all facility information may not be shown. Contact EVERSOURCE MA GAS to have specific field information identified. EVERSOURCE MA GAS disclaims any liability resulting from the reliance by any person on the location shown on this map. Massachusetts law requires that any person performing excavation work contact Dig-Safe so that the location of any underground may be marked.

Address: 136 Dartmouth St WA

City/Town: New Bedford 10/24/16