

APPLICATION/AGREEMENT

For Trench/Disturbance Permit within the City of New Bedford

Permit # 289-10
Dig Safe#20162804887
Date 07/12/2016

JUL 18 2016

TO THE MAYOR AND CITY COUNCIL:

DISTURBANCE PERMIT/TRENCH SAFETY PERMIT

Department of

Permit is hereby requested to excavate the surface of: X City Property and/or X Private Property
Provide Sketch

6513/2

Location of Work: 61 Walden St.
Hillman St. - Maxfield St.Gas leak repairsWork will begin (weather permitting) on: July 26, 2016ROADWAY CLOSURES WILL REQUIRE
AUTHORIZATION FROM THE
COMMISSIONER OF PUBLIC
INFRASTRUCTURE. TRAFFIC MANAGEMENT
PLANS MAY BE REQUIRED.Work will end (weather permitting) on: 60 daysApplicant Name: Craig A. Mello (Craig A. Mello (SS)) Excavator(s) Name: _____FOR INSPECTION ONLY A 24 HOUR
NOTICE IS REQUIRED AND THE
CONTRACTOR/APPLICANT IS
REQUIRED TO NOTIFY THE D.P.I.
@ 508 979-1550 Press 3 RepairCompany Name: Eversource

Hoisting Equipment License Number: _____

Grade: _____ Expiration Date: _____

Contact Number: 508-441-5813

Name & Contact Number of Insurer: _____

Competent Person on Work Site: ON FILEAPPROVED BY: Manuel H. Silva DATE: 7/19/2016TITLE: Supervising Civil Engineer

This permit shall be posted at the work site, and shall remain until the work is completed. It is subject to inspection at all times.

Patch: Curb line to center of roadway
Adjust structures as needed

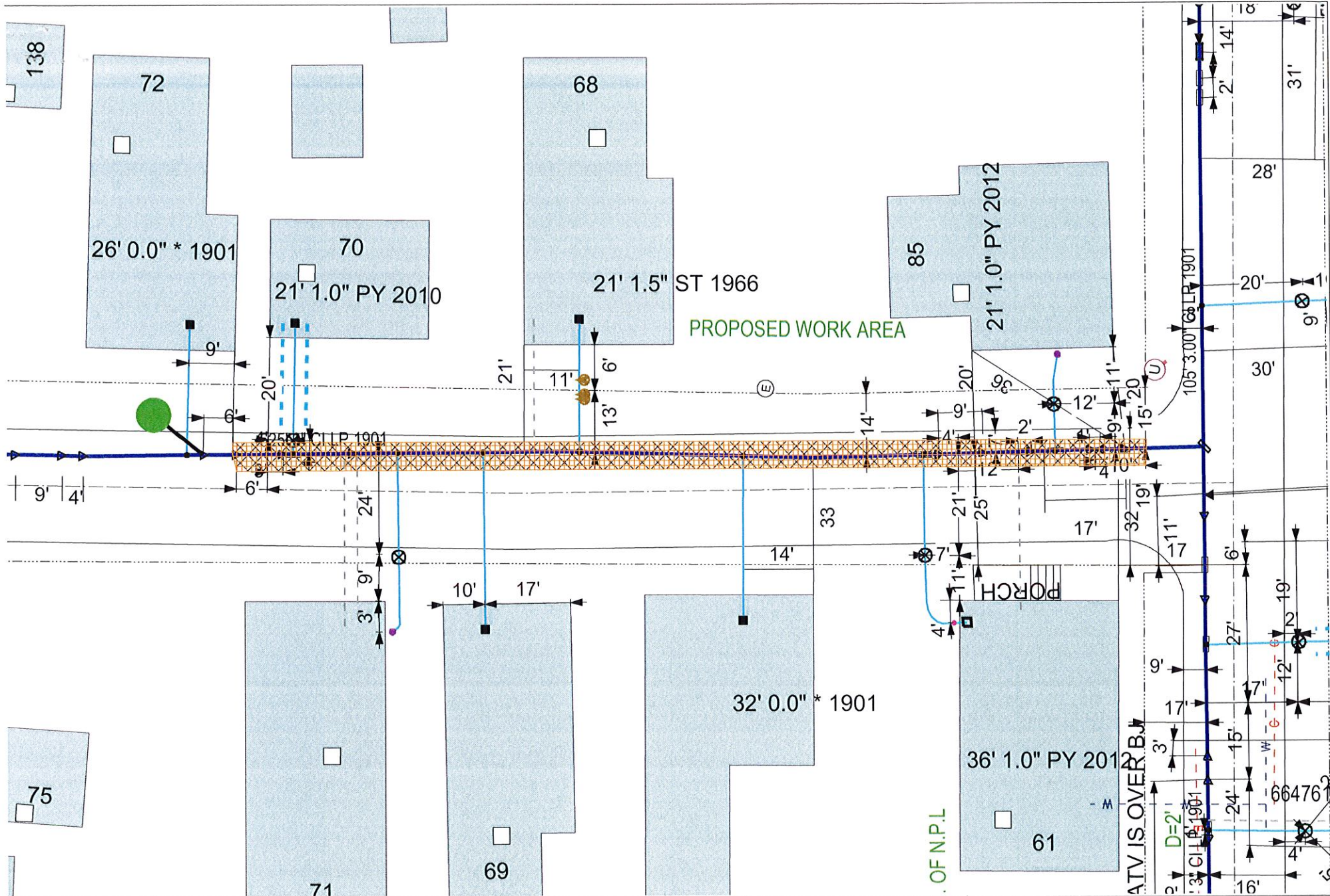

EVERSOURCE

EVERSOURCE MA GAS
One NSTAR Way
Westwood, MA 02090
Phone 1-800-592-2000



MASS LAW
Requires 72 hours advance
notice to Utility Companies
before digging by Anyone

Call Dig-Safe: 811

IMPORTANT - DO NOT SCALE

This drawing provides approximate locations only and all facility information may not be shown. Contact EVERSOURCE MA GAS to have specific field information identified. EVERSOURCE MA GAS disclaims any liability resulting from the reliance by any person on the location shown on this map. Massachusetts law requires that any person performing excavation work contact Dig-Safe so that the location of any underground may be marked.

Address: **61-71 Walden St CAD**

City/Town: **New Bedford 7/1/16**