

APPLICATION/AGREEMENT

For Trench/Disturbance Permit within the City of New Bedford

Permit # 248-16

Dig Safe#20162409177

Date: 06/20/16

TO THE MAYOR AND CITY COUNCIL: DISTURBANCE PERMIT/TRENCH SAFETY PERMIT

Permission is hereby requested to excavate the surface of: X City Property and/or X Private Property
Provide SketchLocation of Work: 212 Lafayette St.Brooklawn Ave. - Wood St.Install Gas ServiceWork will begin (weather permitting) on: July 5, 2016Work will end (weather permitting) on: 60 daysApplicant Name: Craig A. Mello *Craig A. Mello* Excavator(s) Name: Company Name: EversourceHoisting Equipment License Number: Grade: Expiration Date: Contact Number: 508-441-5809Name & Contact Number of Insurer: Competent Person on Work Site: ON FILEAPPROVED BY: Manuel H. Silva DATE: 6/23/2016TITLE: Supervising Civil Engineer

This permit shall be posted at the work site, and shall remain until the work is completed. It is subject to inspection at all times.

6502.02/1

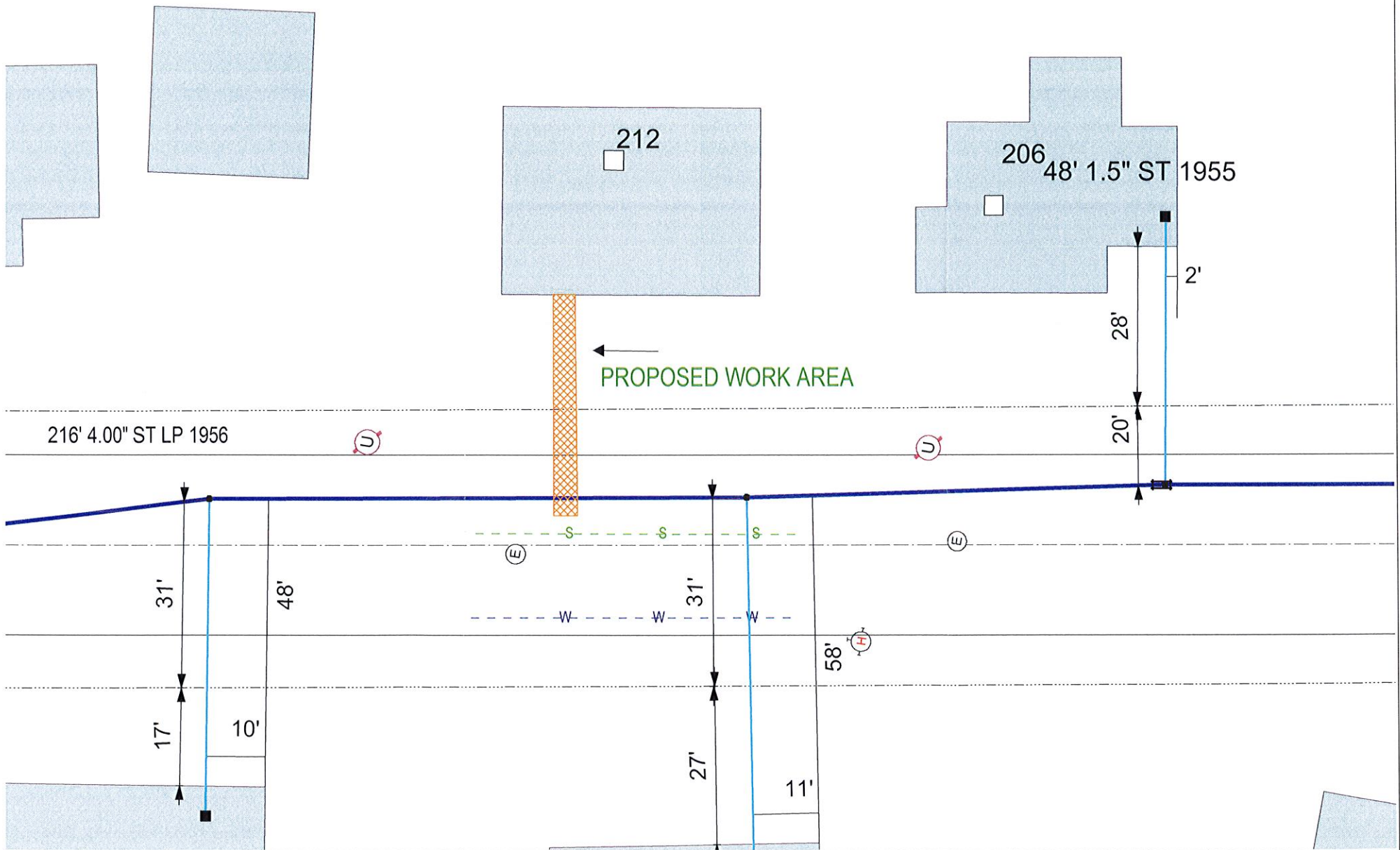

EVERSOURCE

EVERSOURCE MA GAS
One NSTAR Way
Westwood, MA 02090
Phone 1-800-592-2000



MASS LAW
Requires 72 hours advance
notice to Utility Companies
before digging by Anyone

Call Dig-Safe: 811

IMPORTANT - DO NOT SCALE

This drawing provides approximate locations only and all facility information may not be shown. Contact EVERSOURCE MA GAS to have specific field information identified. EVERSOURCE MA GAS disclaims any liability resulting from the reliance by any person on the location shown on this map. Massachusetts law requires that any person performing excavation work contact Dig-Safe so that the location of any underground may be marked.

Address: 212 Lafayette St WAL

City/Town: New Bedford 6/14/16