

APPLICATION/AGREEMENT

For Trench/Disturbance Permit within the City of New Bedford

Permit # 17-16
Dig Safe#20160202952
Date 1/14/16

TO THE MAYOR AND CITY COUNCIL: DISTURBANCE PERMIT/TRENCH SAFETY PERMIT

Permission is hereby requested to excavate the surface of: X City Property and/or X Private Property
Provide Sketch

6503/2

Location of Work: 328 Conduit St.
Dawson St. -Gas Line MaintenanceWork will begin (weather permitting) on: January 28, 2016FOR INSPECTION ONLY A 24 HOUR
NOTICE IS REQUIRED AND THE
CONTRACTOR/APPLICANT IS
REQUIRED TO NOTIFY THE D.P.I.
@ 508 979-1550 Press 3 Repair
PERMIT EXPIRES 1 YEARROADWAY CLOSURES WILL REQUIRE
AUTHORIZATION FROM THE
COMMISSIONER OF PUBLIC
INFRASTRUCTURE. TRAFFIC MANAGEMENT
PLANS MAY BE REQUIRED.Work will end (weather permitting) on: 60 daysApplicant Name: Craig A. Mello

Excavator(s) Name: _____

Company Name: Eversource

Hoisting Equipment License Number: _____

Grade: _____ Expiration Date: _____

Contact Number: 508-441-5809

Name & Contact Number of Insurer: _____

Competent Person on Work Site: ON FILEAPPROVED BY: Manuel H. Silva DATE: 1/20/16TITLE: Supervising Civil Engineer

This permit shall be posted at the work site, and shall remain until the work is completed. It is subject to inspection at all times.

✓

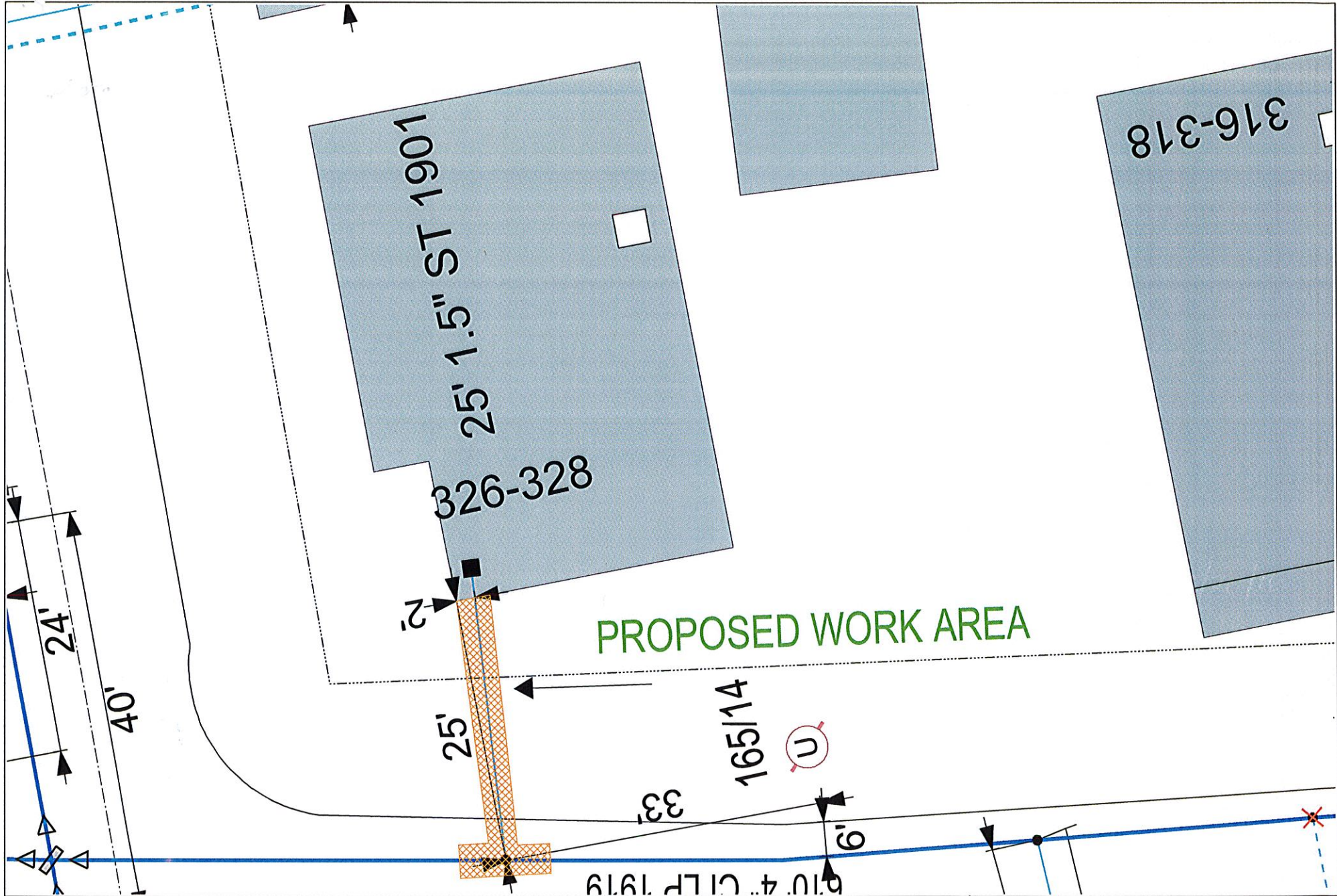

EVERSOURCE

EVERSOURCE MA GAS
One NSTAR Way
Westwood, MA 02090
Phone 1-800-592-2000



MASS LAW
Requires 72 hours advance
notice to Utility Companies
before digging by Anyone

Call Dig-Safe: 811

IMPORTANT - DO NOT SCALE

This drawing provides approximate locations only and all facility information may not be shown. Contact EVERSOURCE MA GAS to have specific field information identified. EVERSOURCE MA GAS disclaims any liability resulting from the reliance by any person on the location shown on this map. Massachusetts law requires that any person performing excavation work contact Dig-Safe so that the location of any underground may be marked.

Address: 328 CONDUIT ST WAL

City/Town: NEW BEDFORD 1/5/16