



CITY OF NEW BEDFORD

MASSACHUSETTS

ENGINEERING - 508-979-1550

EXT. 506

APPLICATION FOR
CONSTRUCTION OF
PAVED
SIDEWALK/ DRIVEWAY

Application No. 11,093

Expires: 8/29/15

Property Owner: Pedro Ferreira Tel: 508-995-4124

Address: 46 Milford St. New Bedford MA 02745
street city state zip code

The above hereby requests permission to construct a paved: ☒ driveway / ☒ sidewalk located at
46 Milford St., plot 113, lot 370 in accordance with the
terms and conditions set forth herein, and the Ordinances of the City of New Bedford.

Sidewalk	Dimensions	Driveway	Width (ft)
<input type="checkbox"/> Bituminous Concrete	<input type="checkbox"/>	<input checked="" type="checkbox"/> Residential	<u>existing 12x13'</u>
<input type="checkbox"/> Concrete Full Width	<input type="checkbox"/>	<input type="checkbox"/> Commercial	<u>hot mix asphalt brow</u>
<input type="checkbox"/> Concrete Ribbon	<input type="checkbox"/>	<input type="checkbox"/> Relocation/Widening	<input type="checkbox"/>
<input type="checkbox"/> Curb Needed	<input type="checkbox"/>	<input type="checkbox"/> Curb Removal	<input type="checkbox"/>
<input type="checkbox"/>	<input type="checkbox"/>	<input checked="" type="checkbox"/> Concrete	<u>install 18'x13'</u>
<input type="checkbox"/>	<input type="checkbox"/>	<input type="checkbox"/> Bituminous Concrete	<u>cement concrete brow</u>

Bonded Contractor: Reis Asphalt Tel: _____

Traffic Commission: _____ Approved _____ Rejected _____ Date _____
Signature _____

Building Dept. _____ Approved (New Building) _____
☒ Approved - Bldg. Permit# B-14-1496
Rejected _____

Danny Romanowicz Signature
Reis Asphalt, - 10/31/14 - (23)
Engineering Department ☒ Approved 8/7/14 Date
Rejected _____
Manuel A. Silva Signature

Permit/Inspection fee of \$150.00 must accompany this application.

SPECIAL REQUIREMENTS:
Contractor to call 24 hrs. in advance for pre-inspection (prior to pouring)
If curbing is removed, it must be returned within 24 hrs to the D.P.I. Yard
1105 Shawmut Ave., New Bedford

PAID: \$150.00

Manuel A. Silva
Supervising Civil Engineer

Property Owner

BY: Jennine Gomez

X



Department of Public Infrastructure

Ronald H. Labelle
Commissioner

CITY OF NEW BEDFORD
Jonathan F. Mitchell, Mayor

Water
Wastewater
Highways
Engineering
Cemetery

To Whom It May Concern:

I Pedro Ferreira, being
(Name) (Mailing Address)

Owner of property located at
46 Milford St

Plot , Lot , hereby agree to allow REIS ASPHALT, INC
(Name)

476 HIXVILLE ROAD, DARTMOUTH to act on my behalf including affixing my
(Mailing Address)

signature in securing permit for:

- ☐ Sewer/Drain Service Permits
- ☒ Water Service Permits
- ☒ Driveway Installation Permits
- ☐ Sidewalk Installation Permits

I further agree to conform to, and abide by, All City rules and ask regulations applicable to
the permit (s) being applied for:

Name X Pedro Ferreira
Signature
Address 46 Milford St
Date 07-27-14 Telephone number 508 9954124

NOTE FROM REIS ASPHALT:
THIS PERMIT IS FOR THE ENTRANCE OF THE DRIVEWAY
AND THE CUSTOMERS PERMIT FEE IS \$150, WHICH WE
ADD TO THE FINAL PRICE OF THE DRIVEWAY IS WE DO
NOT RECEIVE THE CHECK FOR THE CITY BEFOREHAND



Commonwealth of Massachusetts

CITY OF NEW BEDFORD

City Hall, Room 308, 133 William Street New Bedford, MA 02740 (508) 979-1540



BUILDING PERMIT

No. **B-14-1496**

8/29/2014

MSBC Sect. 120.14 - Any permit issued shall be deemed abandoned and invalid unless the work authorized by it shall have been commenced within six (6) months after its issuance.

FEE PAID: **\$30.00**

This certifies that **KRISTAL REIS**

Contractor Lic. # **105097**

ParcelID **113-370**

owner/contractor has permission to: **Driveways - 30.00**

on: **46 MILFORD ST**

Providing that the person accepting this permit shall in every respect conform to the terms of application therefore on file in this office; to the provisions of the statute of the Commonwealth and to the by-laws of the City of New Bedford relating to the inspection, erection, enlarging, altering, raising, moving, repairing, or tearing down of a building.

Permit is issued subject to the following special requirements: (Restrictions)

CITY DEPARTMENT/COMMISSION COMMENTS

BUILDING DEPARTMENT COMMENTS

The following department/commission has expressed concern about the issuance of this permit. You are advised to contact that agency and resolve this matter.

Department/Commission: _____

YOUR AREA INSPECTOR IS: **Thomas Welch**

Tel: (508) 979-1540 Between 8:00am - 9:00am

NOTICE: NOTIFY INSPECTOR 48 HOURS IN ADVANCE OF APPLYING SHEATHING OR LATHING

OCCUPANCY PERMIT REQUIRED BEFORE OCCUPANCY

No Building or Structure shall be used or occupied until the Certificate of Use and Occupancy shall have been issued by the Building Commissioner - MSBC, Sect. 120.1

This Card Must Be Displayed in a Conspicuous Place on the Premises and Not Torn Down or Removed Until Completion of Work

SUBJECT TO MASSACHUSETTS
STATE BUILDING CODE

Danny D. Ronowicz

Building Commissioner

Plan Review Comments:

Manuel Silva

From: Maria Sequeira
Sent: Thursday, August 07, 2014 10:20 AM
To: Maria Pina-Rocha; Manuel Silva; Ana S. Rosa; Donna M. Amado; Rosa DaCosta
Subject: Permit/Application: TB-14-1496 at 46 MILFORD ST for Driveways - 30.00

Please review the permit in the subject line above in the View Permit System. The paper work you need is attached to the application.

Thank you for your attention in this matter.
Maria Sequeira
Department of Inspectional Services

Resurfacing driveway

46 Milford St.
Pedro Ferreira

P113

L370

* Existing 12' x 13' hot mix asphalt brow
No curb
Install 18' x 13' Cement concrete brow

MRS 8/7/14 DPF-ENG



CITY OF NEW BEDFORD
Jonathan F. Mitchell, Mayor

Department of Public Infrastructure

Ronald H. Labelle
Commissioner

Water
Wastewater
Highways
Engineering
Cemetery

To Whom It May Concern:

I Pedro Ferreira, being
(Name) (Mailing Address)

Owner of property located at

46 Milford St

Plot , Lot , hereby agree to allow REIS ASPHALT, INC
(Name)

476 HIXVILLE ROAD, DARTMOUTH to act on my behalf including affixing my
(Mailing Address)

signature in securing permit for:

- ☐ Sewer/Drain Service Permits
- ☒ Water Service Permits
- ☒ Driveway Installation Permits
- ☐ Sidewalk Installation Permits

I further agree to conform to, and abide by, All City rules and ask regulations applicable to the permit (s) being applied for:

Name X Pedro Ferreira
Signature
Address 46 Milford St
Address
Date 07-27-14 Telephone number 508 9954184
Date Telephone number

NOTE FROM REIS ASPHALT:
THIS PERMIT IS FOR THE ENTRANCE OF THE DRIVEWAY
AND THE CUSTOMERS PERMIT FEE IS \$150, WHICH WE
ADD TO THE FINAL PRICE OF THE DRIVEWAY IS WE DO
NOT RECEIVE THE CHECK FOR THE CITY BEFOREHAND

Younger old drivers
OK - Mudd, 8/11/18
Survey is 20' wide

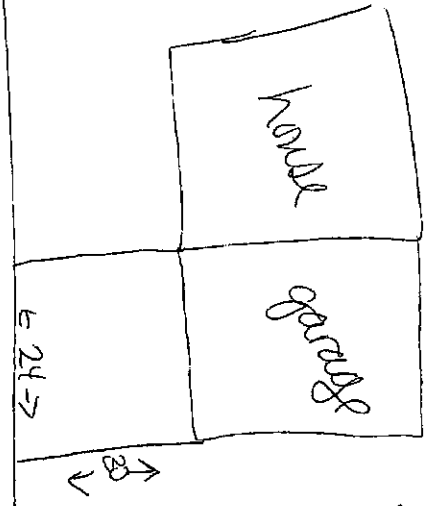

46 Milford

Permit Log Report

MEMO	PLAN	PERMIT NO.	Building	DATE	REMARKS
a41mhs	Reviewed	TB-14-1496	Building	8/7/2014	Engineering-->Approved
a241ms	Reviewed	TB-14-1496	Building	8/7/2014	Engineering-->Pending
COMMENTS					
				8/7/2014	Existing 12'x13' Hot Mix Asphalt brow. No curb. Install 18'x13' Cement Concrete brow.

