



**CITY OF NEW BEDFORD**  
**MASSACHUSETTS**  
**ENGINEERING - 508-979-1526**

**APPLICATION FOR  
CONSTRUCTION OF  
PAVED  
SIDEWALK/DRIVEWAY**

Application No. 10.954

Expires: 11/5/2013  
Date: 11/5/2012

Property Owner: Lindy Machado  
Address: 53 Sable Ave. Dartmouth MA Tel: 508-818-4356  
street city state zip code

The above hereby requests permission to construct a paved: ✓ driveway / ✓ sidewalk located at (55) South Side Westbrook St. 421' 7 1/2' E X John St., plot 33, lot 128 in accordance with the terms and conditions set forth herein, and the Ordinances of the City of New Bedford.

Sidewalk	Dimensions	Driveway	Width (ft)
<input type="checkbox"/> Bituminous Concrete	<input checked="" type="checkbox"/> Residential	<input type="checkbox"/> Concrete	<u>max 18' X 13'</u>
<input type="checkbox"/> Concrete Full Width	<input type="checkbox"/> Commercial	<input type="checkbox"/> Bituminous Concrete	
<input type="checkbox"/> Concrete Ribbon	<input type="checkbox"/> Relocation/Widening		
<input type="checkbox"/> Curb Needed	<input checked="" type="checkbox"/> Curb Removal		

Bonded Contractor: CSBL  
F.S. Almeida Tel: 508-998-3404

Traffic Commission: Approved \_\_\_\_\_ Rejected \_\_\_\_\_ Date \_\_\_\_\_

Building Dept. 11/19 Signature \_\_\_\_\_  
Approved (New Building) \_\_\_\_\_  
Approved - Bldg. Permit# \_\_\_\_\_  
Rejected \_\_\_\_\_

Pre Paid INSURED - 25 - 0404 Signature \_\_\_\_\_  
Engineering Department Approved \_\_\_\_\_ Rejected \_\_\_\_\_ Date \_\_\_\_\_  
Pending  
Site Engineer  
Site Visit Signature \_\_\_\_\_

Permit/Inspection fee of \$150.00 must accompany this application.  
SPECIAL REQUIREMENTS: Contractor to call 24 hrs. in advance for pre-inspection (prior to pouring)  
If curbing is removed, it must be returned within 24 hrs to the D.P.L. Yard  
1105 Shawmut Ave., New Bedford

Supervising Civil Engineer Manuel A. Silva

BY: Carol Freeman \$150.00 PAID: \_\_\_\_\_  
Property Owner

Property Owner's Representative

ACTION TO BE TAKEN AND THE DEADLINE FOR TAKING SUCH ACTION:

EFFECTIVE WITHIN 15 DAYS OF RECEIPT OF THIS NOTICE, the Acushnet Water Department shall submit to the MassDEP, Southeast Regional Office two completed and executed "Certified Operator Compliance Notices". One Notice for the primary operator and one for the secondary operator. A copy of said notice is attached for your convenience.

If you have any questions concerning this matter, please contact Charles Shurtleff at (508) 946-2879.

DATE:

3/21/13

BY:



Richard J. Rondeau, Chief  
Drinking Water Program  
Bureau of Resource Protection

# GENERAL NOTES TO CONTRACTOR FOR SITE

- IT SHALL BE THE CONTRACTOR'S SOLE RESPONSIBILITY TO OBTAIN ANY AND ALL PERMITS REQUIRED BY THE STATE OF MASSACHUSETTS AND THE CITY OF NEW BEDFORD PRIOR TO COMMENCING ANY WORK.
- ELEVATION SHOWN ARE BASED ON CITY OF NEW BEDFORD DATUM +70 (RIM OF EXISTING SANITARY MANHOLE ON WESTBROOK STREET. EL. = 94.00)
- THE LOCATION OF EXISTING UNDERGROUND UTILITIES SHOWN ON THIS PLAN IS APPROXIMATE. PRIOR TO ANY EXCAVATION ON THIS SITE, THE EXCAVATING CONTRACTOR SHALL MAKE THE REQUIRED 72 HOUR NOTIFICATION TO DIG SAFE (1-888-344-7233) AND ANY OTHER UTILITIES WHICH MAY HAVE CABLE, PIPE OR EQUIPMENT IN THE CONSTRUCTION AREA FOR VERIFICATION OF LOCATIONS.
- THE LOCATION OF EXISTING UTILITIES, WATER AND SEWER SYSTEMS WERE OBTAINED FROM VARIOUS SOURCES OF INFORMATION. THE EXACT LOCATION AND COMPLETENESS IS NOT GUARANTEED. LOCATION AND DEPTH OF UTILITIES AND PROPERTY LINE INFORMATION IS TAKEN FROM CITY OF NEW BEDFORD DPW SEWER PLANS.
- THE CONTRACTOR SHALL BE RESPONSIBLE TO REVIEW THE CONSTRUCTION DRAWING AND TO NOTIFY THE ENGINEER WITH ANY DISCREPANCY BETWEEN THE DESIGN AND THE MANUFACTURER'S REQUIREMENTS AND ALL LOCAL, STATE AND FEDERAL CODES.
- THE CONTRACTOR SHALL BE RESPONSIBLE FOR THE SECURITY AND JOB SAFETY ON THE SITE. THE CONSTRUCTION SHALL BE PERFORMED IN ACCORDANCE WITH "OSHA" AND THE LOCAL MUNICIPALITY CONSTRUCTION STANDARDS.
- THE CONTRACTOR SHALL PROVIDE ALL MATERIALS, LABOR, SUPERVISION, TOOLS, EQUIPMENT, FUEL, POWER, SANITARY FACILITIES AND INCIDENTALS NECESSARY FOR THE FURNISHING, PERFORMANCE TESTING, START-UP AND COMPLETION OF THIS WORK.
- THE CONTRACTOR SHALL BE RESPONSIBLE TO DISPOSE OF ANY UNSUITABLE OR SURPLUS MATERIALS PROPERLY OFF SITE IN ACCORDANCE WITH LOCAL AND STATE ENVIRONMENTAL CODES.
- THE CONTRACTOR SHALL CONFIRM SEWER DEPTH AND INVERT ELEVATIONS PRIOR TO CONSTRUCTION. ANY DISCREPANCIES SHALL BE REPORTED TO THE ENGINEER IMMEDIATELY.
- THE CONTRACTOR SHALL MAINTAIN ALL EXCAVATION IN DRY CONDITIONS.
- ALL EXISTING UTILITIES WATER, GAS, DRAINS, & ELECTRIC SHALL BE PROPERLY PROTECTED AND MAINTAINED DURING THE CONSTRUCTION PERIOD.
- ANY DEVIATION FROM THE CONTENT OF THESE PLANS WITHOUT WRITTEN CONSENT OF THIS ENGINEER WOULD MAKE IT NULL AND VOID.
- IN CASE OF A CONFLICT BETWEEN THE PROPOSED WORK SHOWN ON THIS PLAN AND THE APPLICABLE LOCAL AND STATE CODES, THE APPLICABLE CODES SHALL GOVERN.
- THE CONTRACTOR SHALL SHORE, BRACE, SHEET PILE OR OTHERWISE SUPPORT THE EXISTING BUILDING, UTILITIES AND STREETS NEXT TO THE PROPOSED EXCAVATION.
- ALL CONSTRUCTION MATERIAL, COMPONENTS, AND METHODS EMPLOYED ON THIS PROJECT WORK SHALL CONFORM TO THE CITY OF NEW BEDFORD DEPARTMENT OF PUBLIC WORKS STANDARD SPECIFICATIONS AS AMENDED TO PRESENT.
- DESIGN LOADING FOR ALL PRE CAST UNITS TO BE AASHTO-H20 UNLESS NOTED.
- THIS PLAN IS FOR PROPOSED WORK ONLY AND IS NOT TO BE USED FOR PROPERTY LINE STAKING.
- 8" LOAM AND SEED ALL DISTURBED AREAS NOT PAVED.
- SEWER MANHOLE AND SERVICE WITHIN ROADWAY LAYOUT MUST BE TESTED FOR LEAKS BEFORE THE DWELLING IS CONNECTED.
- THE APPLICANT WILL BE RESPONSIBLE FOR FILING AN "APPLICATION OF INSPECTIONAL SERVICES" WITH THE D.P.W. AND PAY THE REQUIRED FEES FOR THE DEPARTMENT TO INSPECT THE PROJECT.

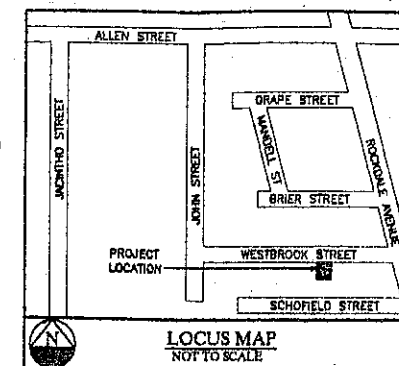

SYMBOL	DESCRIPTION
---	PROPERTY LINE
---	EXIST. SEWER LINE
---	PROP. SEWER LINE
---	EXIST. WATER LINE
---	EXIST. GAS LINE
○ SMH	EXIST. SEWER MANHOLE
○ UP	EXIST. UTILITY POLE
---	EXIST. FENCE

**SITE DATA:**  
 ADDRESS: LOT 128 WESTBROOK STREET, DARTMOUTH, MA  
 ASSESSORS MAP 33 PARCEL 128  
 ZONING DISTRICT: RESIDENCE  
 AREA: 7,984 Sq.Ft. (.18 Acre)

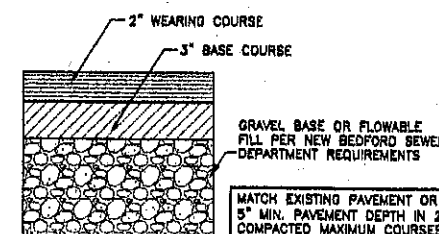

PAVING DETAIL  
NOT TO SCALE

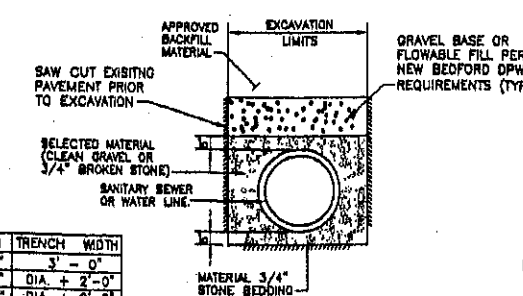

PIPE (I.D.)	TRENCH WIDTH
4" - 12"	3' - 0"
15" - 24"	DIA. + 2'-0"
27" - 36"	DIA. + 2'-8"
OVER 36"	DIA. + 3'-0"

PIPE BEDDING & TRENCH DETAIL  
NOT TO SCALE

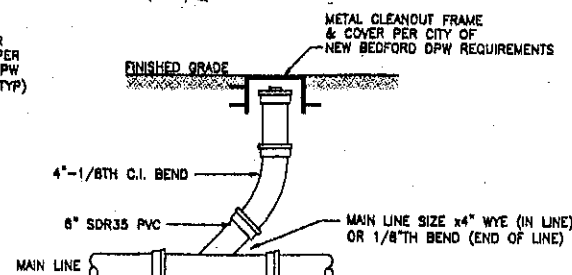

GROUND CLEANOUT DETAIL  
NOT TO SCALE

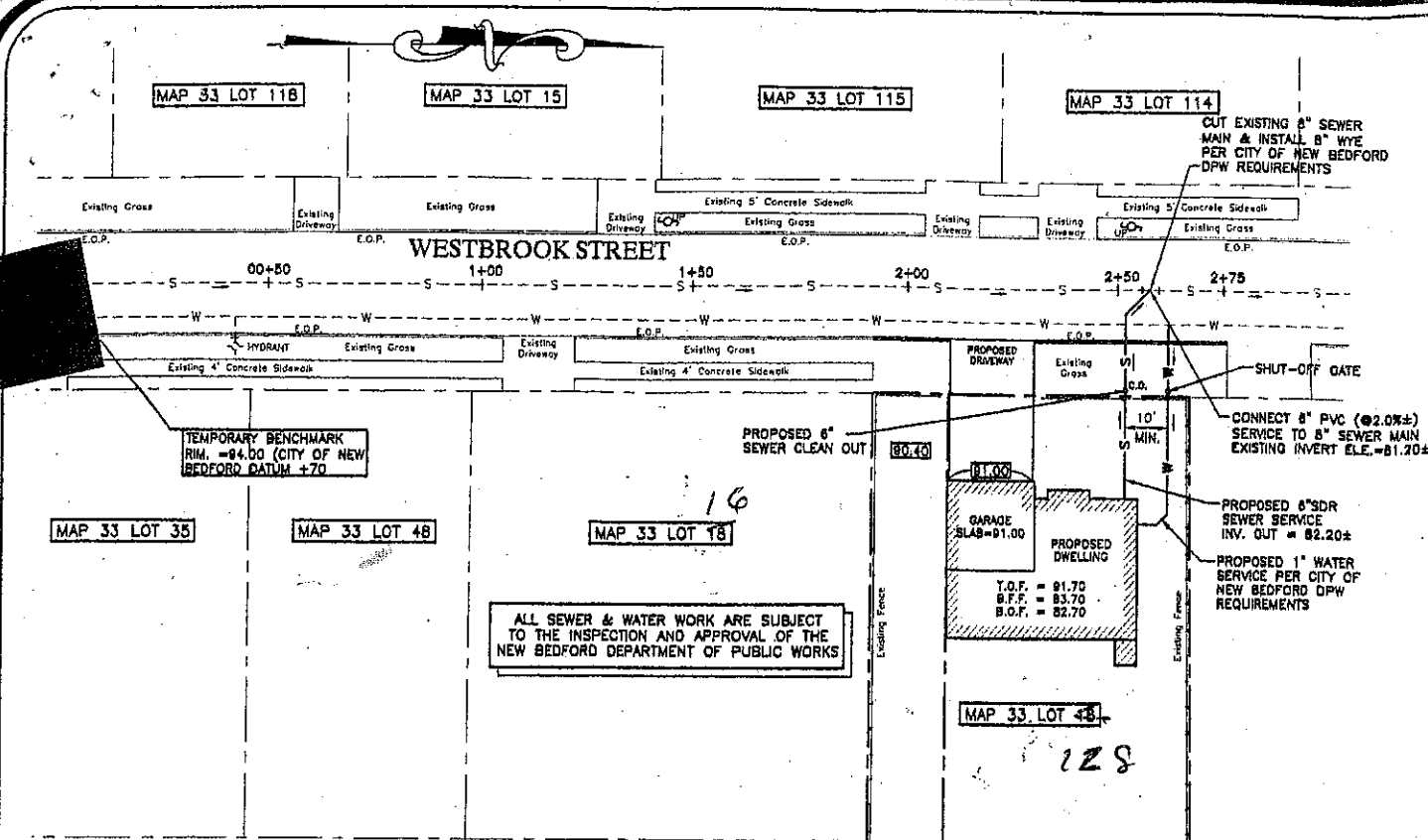

WESTBROOK STREET PLAN VIEW

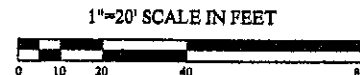

T.O.F. = TOP OF FOUNDATION  
 B.F.F. = BASEMENT CONCRETE FLOOR  
 B.O.F. = BOTTOM OF FOOTING  
 80.00 = PROPOSED CONTOUR ELEVATION

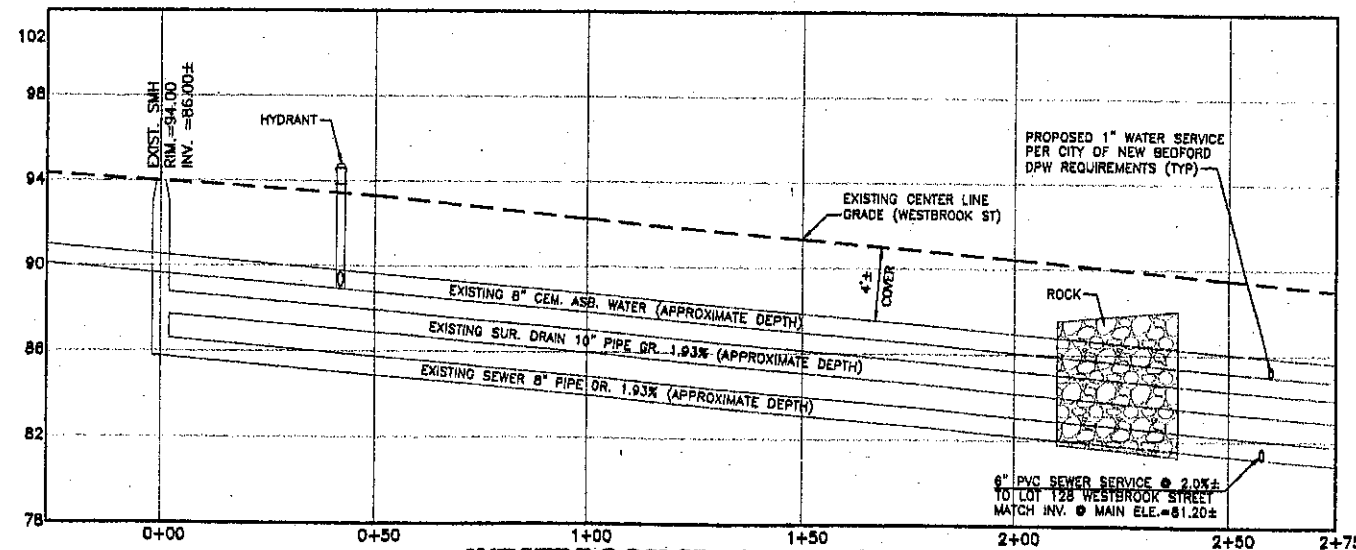

WESTBROOK STREET PROFILE

HORIZONTAL SCALE: 1" = 20'  
 VERTICAL SCALE: 1" = 4'

CHOUBAH ENGINEERING GROUP, P.C.  
**CEG**  
 CONSULTING PROFESSIONAL ENGINEERS  
 112 STATE ROAD (ROUTE 9),  
 No. DARTMOUTH, MA 02747  
 TEL: (508) 858-5040 FAX: (508) 858-5041  
 www.choubahgroup.com

Project:  
 PROPOSED DWELLING  
 LOT 128  
 WESTBROOK STREET  
 NEW BEDFORD, MA

Prepared For:  
 CINDY MACHADO  
 LOT 128  
 WESTBROOK STREET  
 NEW BEDFORD, MA

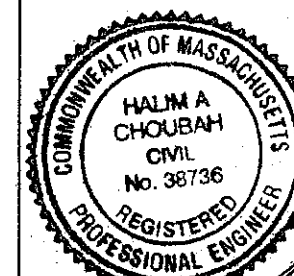

Issue Date: 06/07/2012

Revisions		
No.	Date	Description

Project Number: 12-340  
 Scale: AS SHOWN  
 Designed By: IBS  
 Drawn By: IBS  
 Checked By: HC

Sheet Title:  
 SEWER & WATER  
 SERVICE PLAN

Sheet Number: 1 OF 1