

CITY OF NEW BEDFORD  
DEPARTMENT OF PUBLIC WORKS  
100 STATE STREET  
NEW BEDFORD, MA 01909  
TELEPHONE: 508/457-1234  
FAX: 508/457-1235  
E-MAIL: DEPT@CITYOFNB.EDU

JOHN F. KENNEDY MEMORIAL  
HIGHWAY AT UNION STREET

GENERAL NOTES:  
1. ALL WORK SHALL BE DONE IN ACCORD WITH THE LATEST EDITIONS OF THE MASSACHUSETTS DEPARTMENT OF TRANSPORTATION (M.D.T.) STANDARD SPECIFICATIONS FOR HIGHWAYS, BRIDGES, AND STRUCTURES, AND THE M.D.T. STANDARD SPECIFICATIONS FOR SIGNALS AND TRAFFIC CONTROL DEVICES.  
2. THE CONTRACTOR SHALL BE RESPONSIBLE FOR OBTAINING ALL NECESSARY PERMITS FROM THE CITY OF NEW BEDFORD AND THE MASSACHUSETTS DEPARTMENT OF TRANSPORTATION.  
3. THE CONTRACTOR SHALL BE RESPONSIBLE FOR THE PROTECTION OF ALL EXISTING UTILITIES AND STRUCTURES.  
4. THE CONTRACTOR SHALL BE RESPONSIBLE FOR THE MAINTENANCE OF ALL TRAFFIC CONTROL DEVICES AND SIGNALS.

TEMPORARY TRAFFIC SIGNAL PLAN:  
1. THE TEMPORARY TRAFFIC SIGNAL SHALL BE INSTALLED AT THE INTERSECTION OF JOHN F. KENNEDY HIGHWAY AND UNION STREET.  
2. THE TEMPORARY TRAFFIC SIGNAL SHALL BE INSTALLED IN ACCORD WITH THE M.D.T. STANDARD SPECIFICATIONS FOR SIGNALS AND TRAFFIC CONTROL DEVICES.  
3. THE TEMPORARY TRAFFIC SIGNAL SHALL BE INSTALLED IN ACCORD WITH THE M.D.T. STANDARD SPECIFICATIONS FOR SIGNALS AND TRAFFIC CONTROL DEVICES.

MAJOR ITEMS LIST

ITEM	QUANTITY	UNIT	DESCRIPTION
1	1	LOT	TEMPORARY TRAFFIC SIGNAL
2	1	LOT	TEMPORARY TRAFFIC SIGNAL
3	1	LOT	TEMPORARY TRAFFIC SIGNAL
4	1	LOT	TEMPORARY TRAFFIC SIGNAL

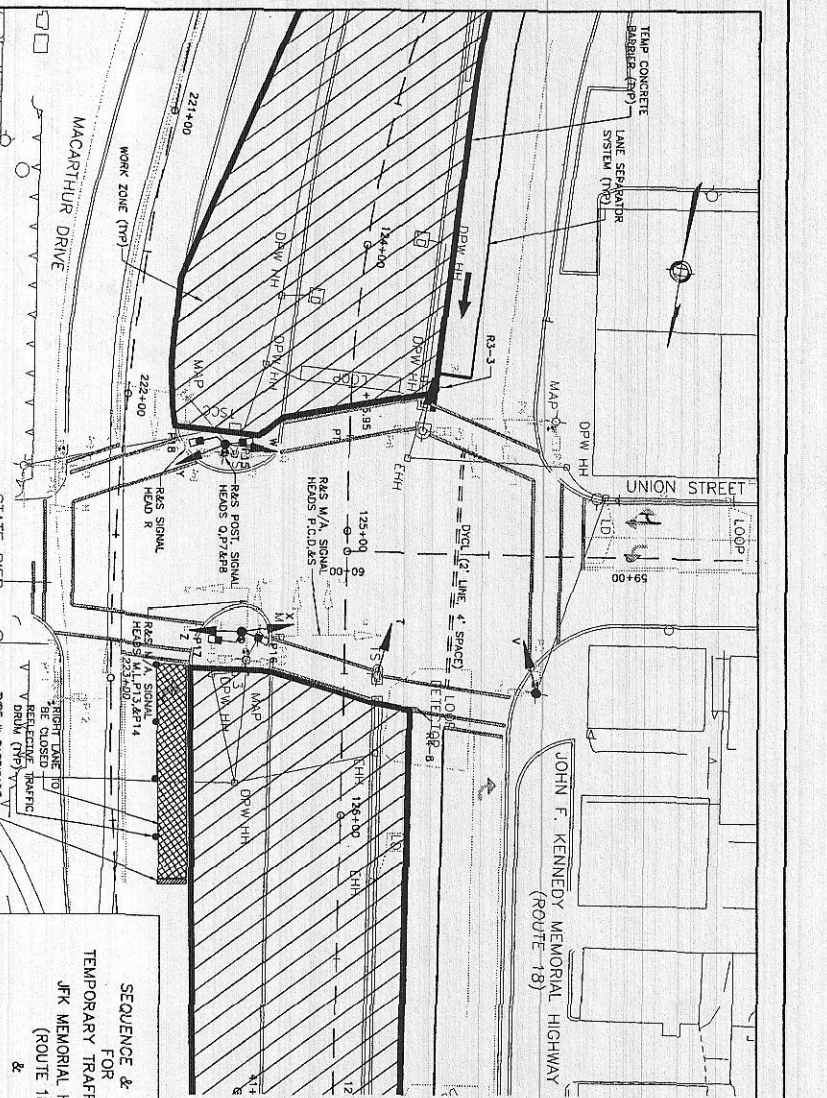

SIGNAL FACES - EXISTING

LOCATION	TYPE	SIZE	COLOR
STATE STREET	ROUND	18"	RED
STATE STREET	ROUND	18"	RED
STATE STREET	ROUND	18"	RED
STATE STREET	ROUND	18"	RED

SIGNAL FACES - PROPOSED (TEMPORARY)

LOCATION	TYPE	SIZE	COLOR
STATE STREET	ROUND	18"	RED
STATE STREET	ROUND	18"	RED
STATE STREET	ROUND	18"	RED
STATE STREET	ROUND	18"	RED

SEQUENCE & TIMING  
FOR  
TEMPORARY TRAFFIC SIGNAL  
(ROUTE 1B)  
SEMI-ACTIVATED CONTROL

PHASE	SEQUENCE	TIME (SECONDS)
1	1	10
2	2	10
3	3	10
4	4	10
5	5	10
6	6	10
7	7	10
8	8	10
9	9	10
10	10	10
11	11	10
12	12	10
13	13	10
14	14	10
15	15	10
16	16	10
17	17	10
18	18	10
19	19	10
20	20	10
21	21	10
22	22	10
23	23	10
24	24	10
25	25	10
26	26	10
27	27	10
28	28	10
29	29	10
30	30	10
31	31	10
32	32	10
33	33	10
34	34	10
35	35	10
36	36	10
37	37	10
38	38	10
39	39	10
40	40	10
41	41	10
42	42	10
43	43	10
44	44	10
45	45	10
46	46	10
47	47	10
48	48	10
49	49	10
50	50	10
51	51	10
52	52	10
53	53	10
54	54	10
55	55	10
56	56	10
57	57	10
58	58	10
59	59	10
60	60	10
61	61	10
62	62	10
63	63	10
64	64	10
65	65	10
66	66	10
67	67	10
68	68	10
69	69	10
70	70	10
71	71	10
72	72	10
73	73	10
74	74	10
75	75	10
76	76	10
77	77	10
78	78	10
79	79	10
80	80	10
81	81	10
82	82	10
83	83	10
84	84	10
85	85	10
86	86	10
87	87	10
88	88	10
89	89	10
90	90	10
91	91	10
92	92	10
93	93	10
94	94	10
95	95	10
96	96	10
97	97	10
98	98	10
99	99	10
100	100	10

APPLIES TO SIGNALS  
ON ROUTE 1B  
INTERSECTION